

# Aluminium Bi-Fold Doors

Site Fitting Instructions

## Frame assembly

Only if supplied in Kit form

Screw thru jamba into Head & Sill. Making sure that all components are position correctly. ( See details 1)

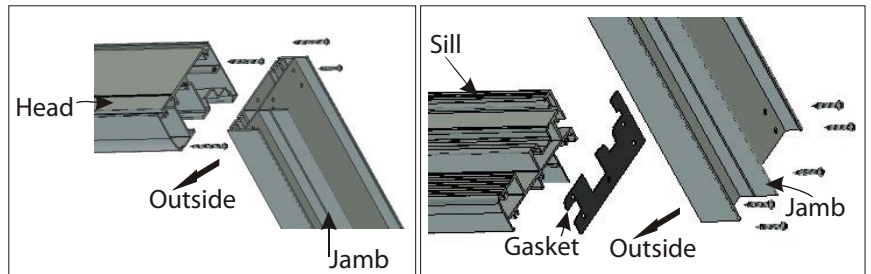

Details 1

## Timber Reveal Fitting

Only if supplied in Kit form

Fitted to Head and either Jamb. Nailed or screwed through aluminium fin from the outside face. ( See details 2)

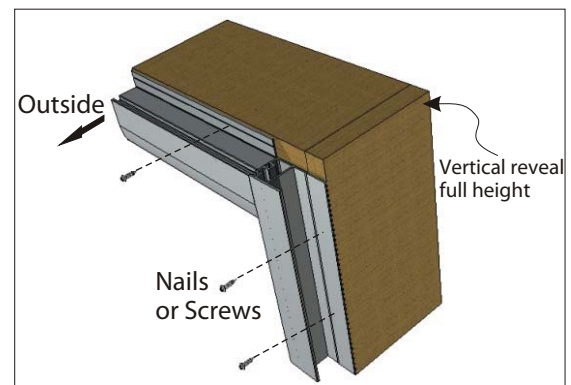

Details 2

## Note

For all Bi-Fold frame installation

## Frame Building Details

- Build Head in with a 3mm camber
- Screw head in the top rail track ensuring the 3 mm camber.
- Check diagonals of the frame

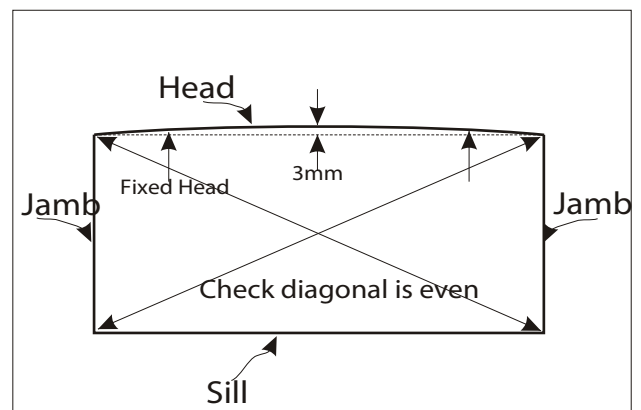

## Frame Building-in Details

Refer to attached sheet on building-in diagrams for Brick Veneer, Double Brick & Clad construction

# Aluminium Bi-Fold Doors

Site Fitting Instructions

## Brick Veneer Construction

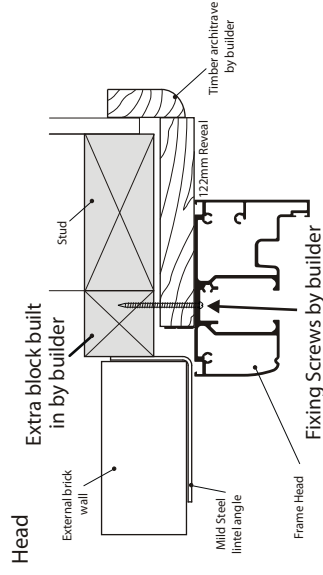

## Double Brick Construction

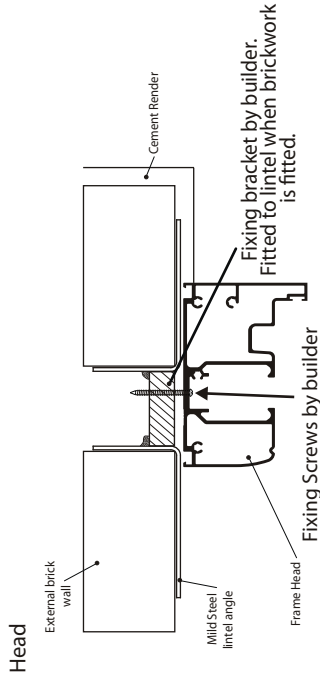

## Clad Construction

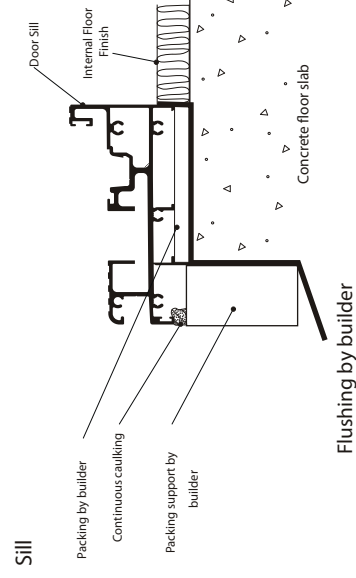
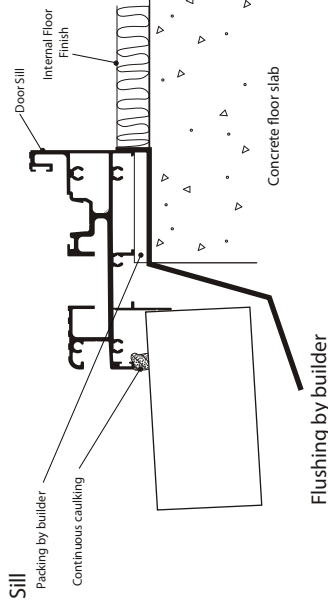
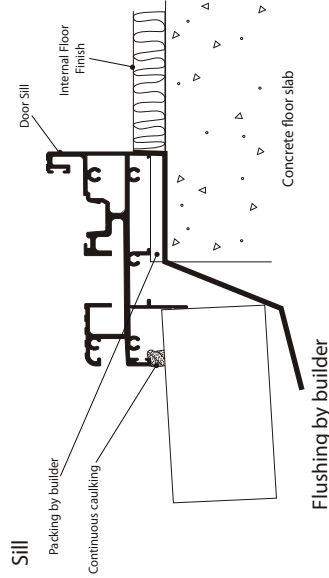
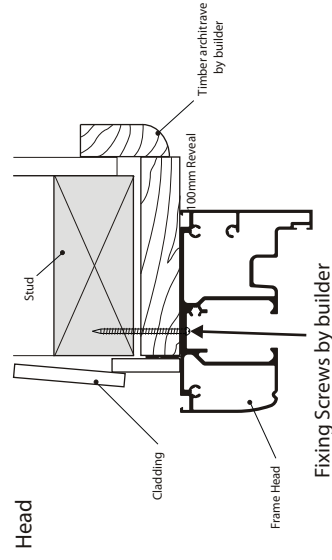

# Aluminium Bi-Fold Doors

Site Fitting Instructions | 4L - 1R Configuration

1. All doors are marked with a letter on the top of the top rail. Viewed from outside "Door A" will be on the left hand side

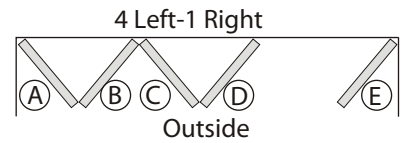

2. Remove top pivot block, located in the top corners of the head track. Remove screws & plate back towards you. Slide block out of punched head track as shown in detail 3



Detail 3

3. Select "Door D". Viewed from outside, the roller carrier will be position on the right hand side (detail 4). Remove roller from hinge. Keep pin on hand.



Detail 4

Turn pin to unwind roller from Hinge.

Insert roller into head end cut out. Door "D" place bottom guide into sill track, refit roller & pin back to hinge



Detail 5

Put pin back up into roller

4. Select "Door B" and repeat process as above. DO NOT SCREW DOORS TOGETHER

5. Refit top pivot block back into head track.(Detail 6-7)



Detail 6

Top pivot put back into head



Detail 7

Plate screwed back into top pivot block

# Aluminium Bi-Fold Doors

Site Fitting Instructions | 4L - 1R Configuration

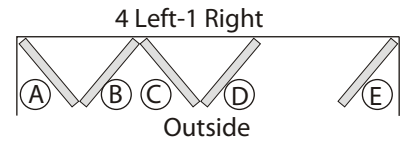

6. Select "Door A" with the bottom hinge still fixed to the door lift the door onto the sill pivot block. With the pin that was removed from the top, slide it back into the hinge and screw to top pivot block

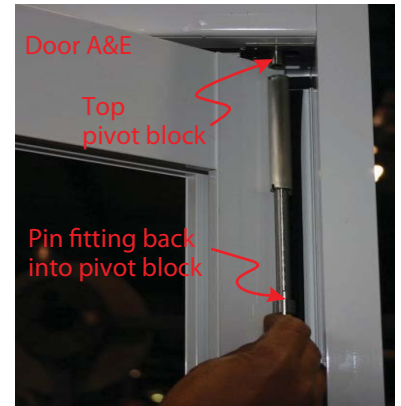

Detail 8

7. Fit "Door E". This procedure is the same as "Door A"

8. You can screw "Door A" to "Door B", "Door B" to "Door C" and "Door C" to "Door D". (Detail 9)



Detail 9

9. Doors can be adjusted Horizontally both top and bottom ends. This is achieved by turning the adjustment screw in or out.(Detail 10&11)

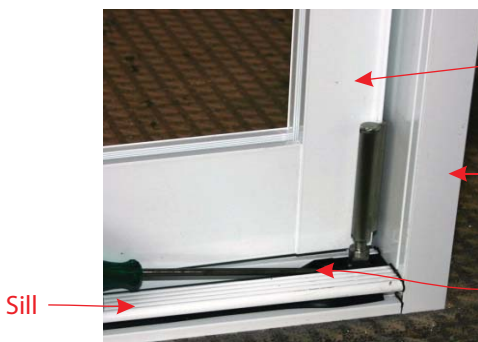

Detail 10

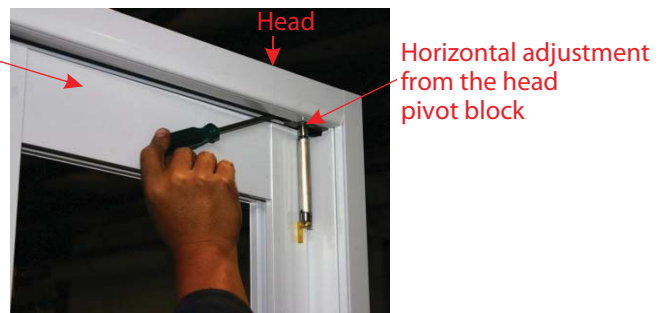

Detail 11

Doors can be adjusted Vertically. Adjust the top hinge by screwing the hinge up or down. When you have the correct height, remove the Red Tag. This will lock the door into place.

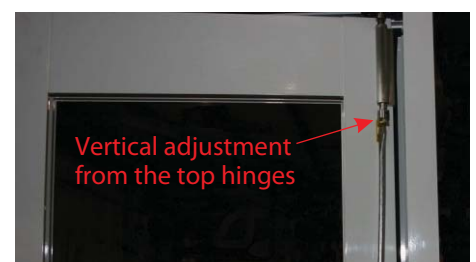

Detail 12