

Weser

WY103

Concealed Cistern
(with Full Frame)

Installation Demo

Parts Included in WY103 Full Frame Concealed Cistern

2) Actuator Plate

3) Wall-mount L-bracket 2x

4) Actuator Bracket Set (Incl. temporary cover 1x, Adjusting Rod 2x, Button Rod 2x)

5) WC Mounting Screw Set 2x

6) Floor-mount Anchor Bolt 4x

7) Straight Pipe + Connector

8) Converter mounting bracket

9) P-S Converter (Adjustable Length)



1) WY103 installed on Full Frame

Step 1:

Install P-S Converter onto the frame, by using Converter Mounting Bracket provided.



Converter mounting bracket

P-S Converter
(Adjustable Length)

Inlet Pipe

Straight Pipe

Pipe Connector

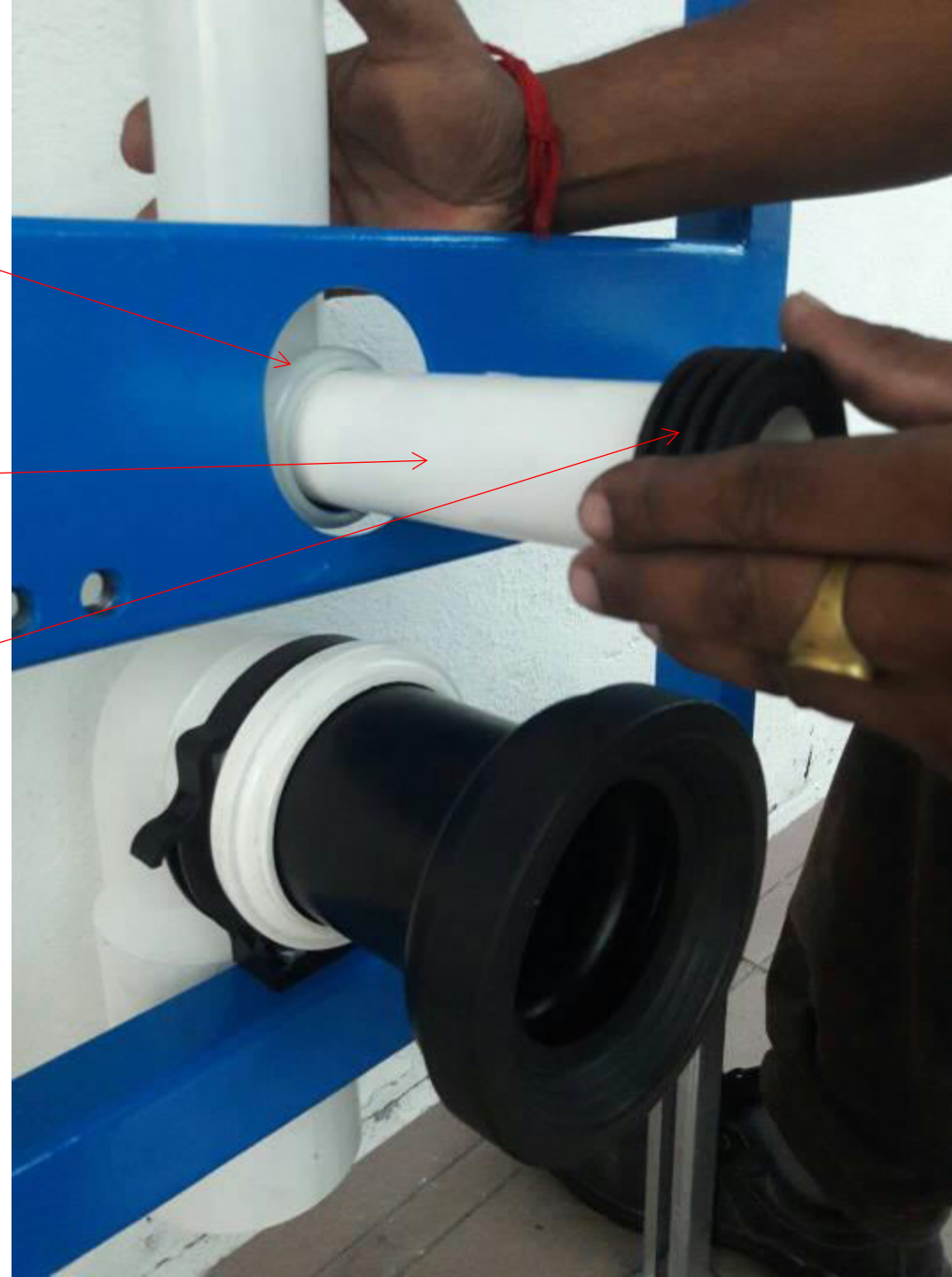

Step 2:

Install Straight Pipe (with Pipe Connector) onto Inlet Pipe

Step 3:

Install WC Mounting Screw Set (on both sides).

Note: Please refer to WC datasheet to determine hole-to-hole pitch (either 230mm OR 180mm)

Outer hole is 230mm pitch

Inner hole is 180mm pitch

WC Mounting Screw Set

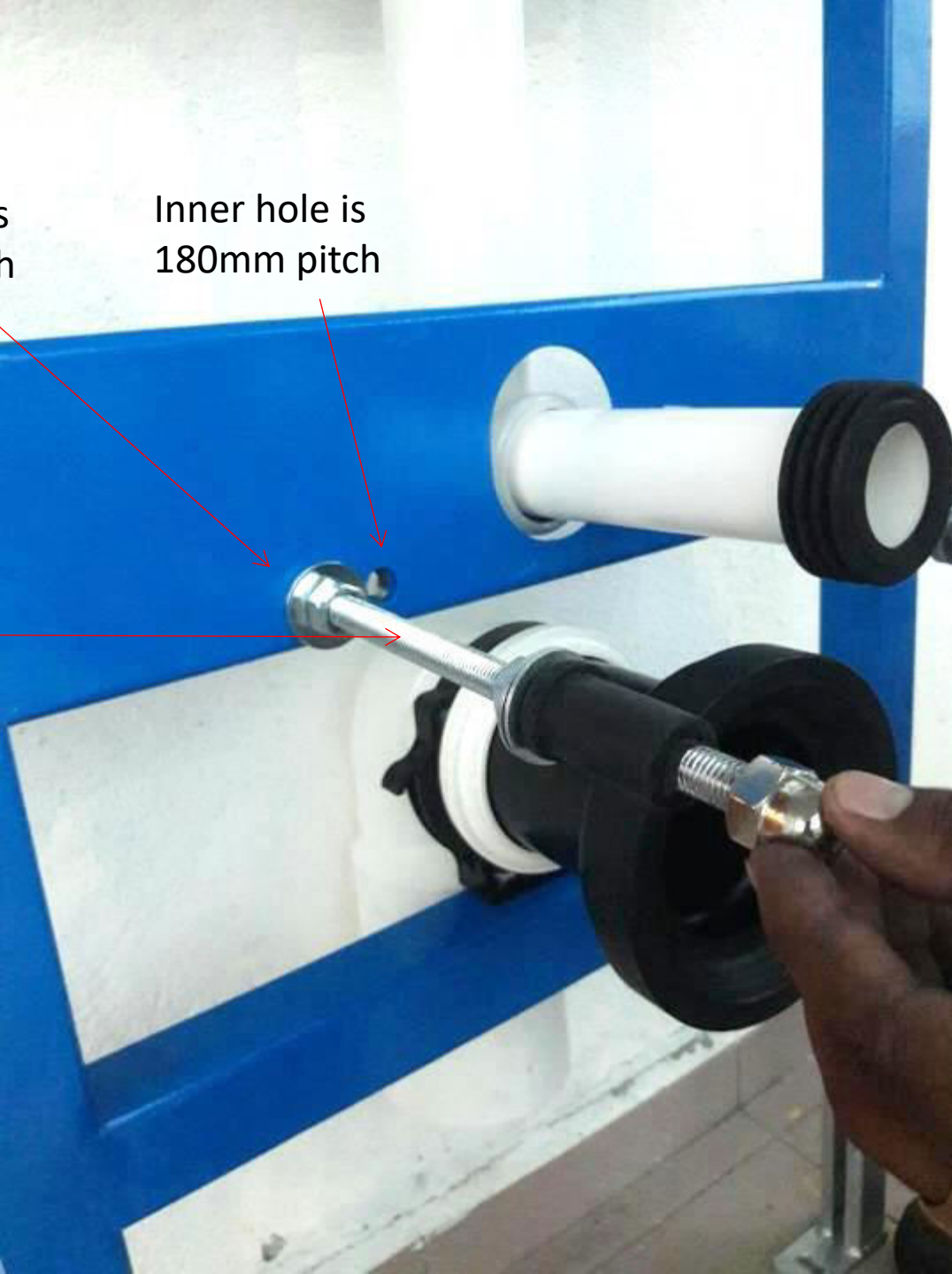

Actuator
Bracket



Step 4:

Install Actuator Bracket onto the Cistern (by tightening screws at four corners)

Temporary
Cover



Step 5:

Install Temporary Cover onto Actuator Bracket, (latch on, no screws)
Note: The temporary cover is to prevent foreign materials from dropping into inside of cistern during installation works)



Step 6:

Install the left side adjustable legs of the frame onto solid floor (to hold the frame firmly), by using anchor bolt. Repeat for the right side.

Determine the desired FFL (Finished Floor Level).
Mark the FFL on the leg.

Adjustable
leg of frame

FFL (Finished Floor Level)

Anchor
Bolt



Wall-mount
L-bracket



Step 7:

Install one wall-mount L-bracket each onto the Top Left corner and Top Right corner of the frame.

Adjust the height of frame to desired level (although we recommend 1-m level mark on Cistern to be exactly 1m from FFL (finished floor level)).

Then mount the L-bracket onto solid wall (to hold the frame firmly), by using anchor bolt.

Solid Wall

Anchor
Bolt



Leveling Gauge



Step 8

Check leveling of the frame to ensure it is level, before tightening the four anchor bolts (two each on Wall-mount L-bracket and Adjustable Legs) to ensure the frame is firmly held.

This is the last step of installation before cement, plastering and tiling works begin.

Final Installation AFTER cement works,
plastering and tiling works are done

Temporary Cover

FFL →



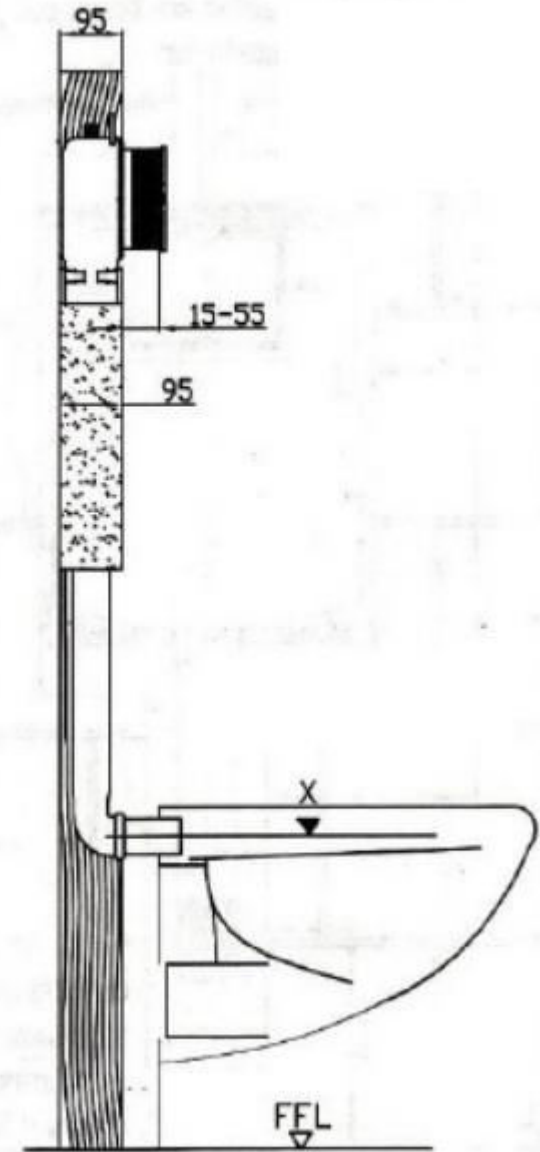
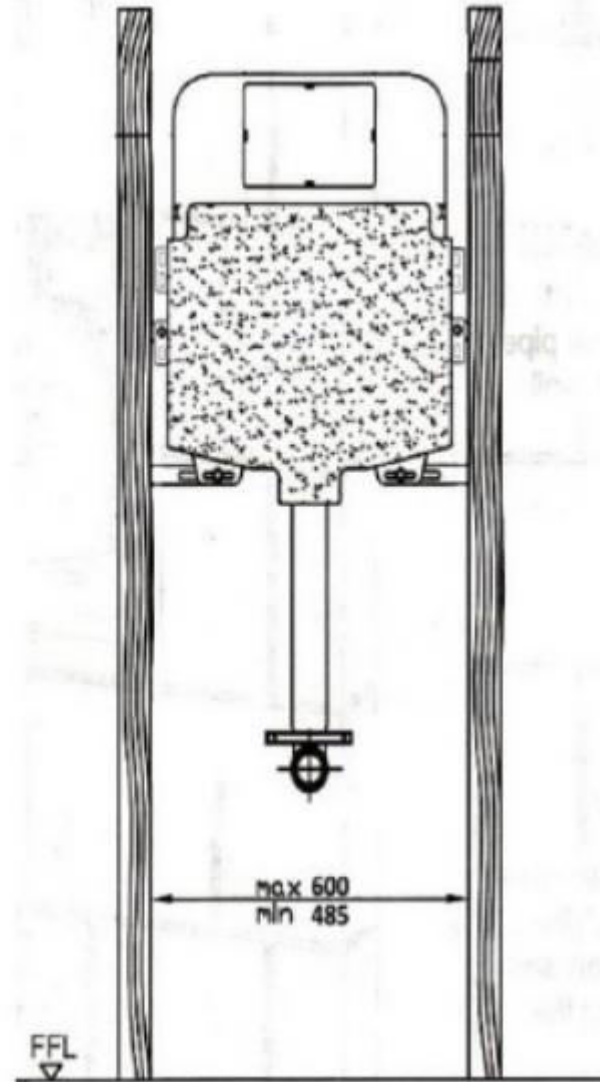
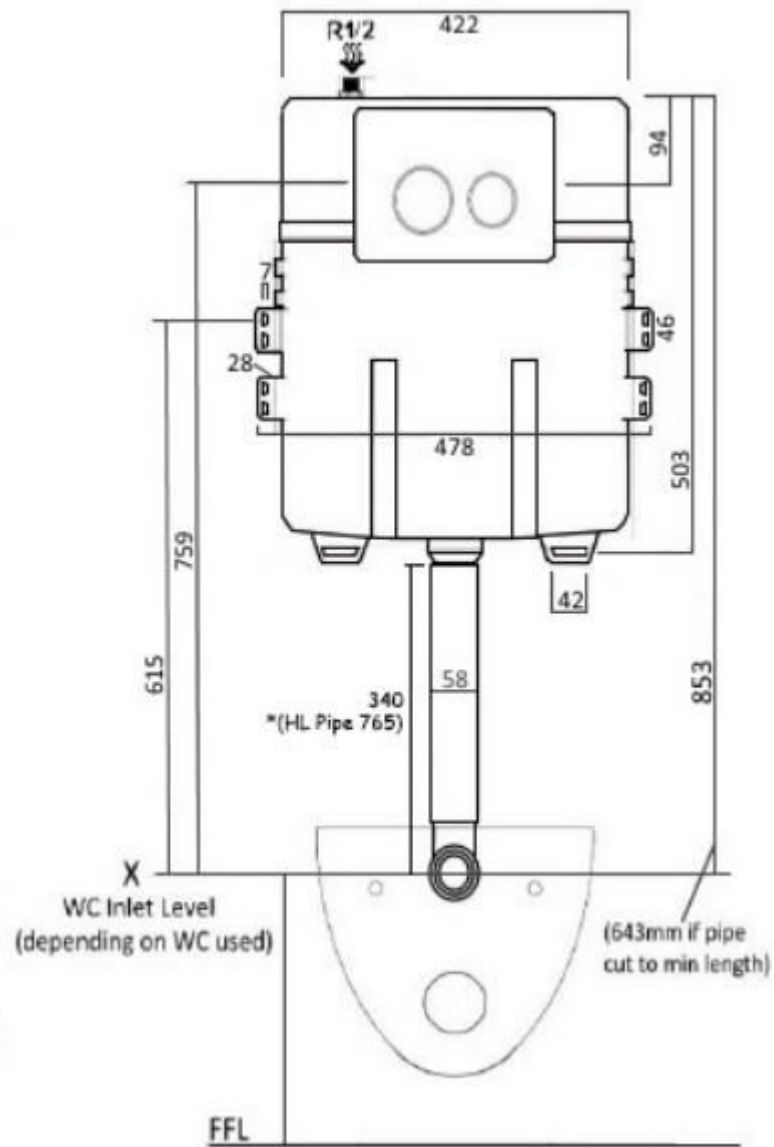

Note: All dimensions in mm; FFL=Finished floor level; X= Connection Height / WC Inlet Level.

Confirm WC Dimension

*Please refer to WC drawings

WC Top

Inlet Level

Chair Bracket Screw Level

Outlet Level

Finished Floor Level

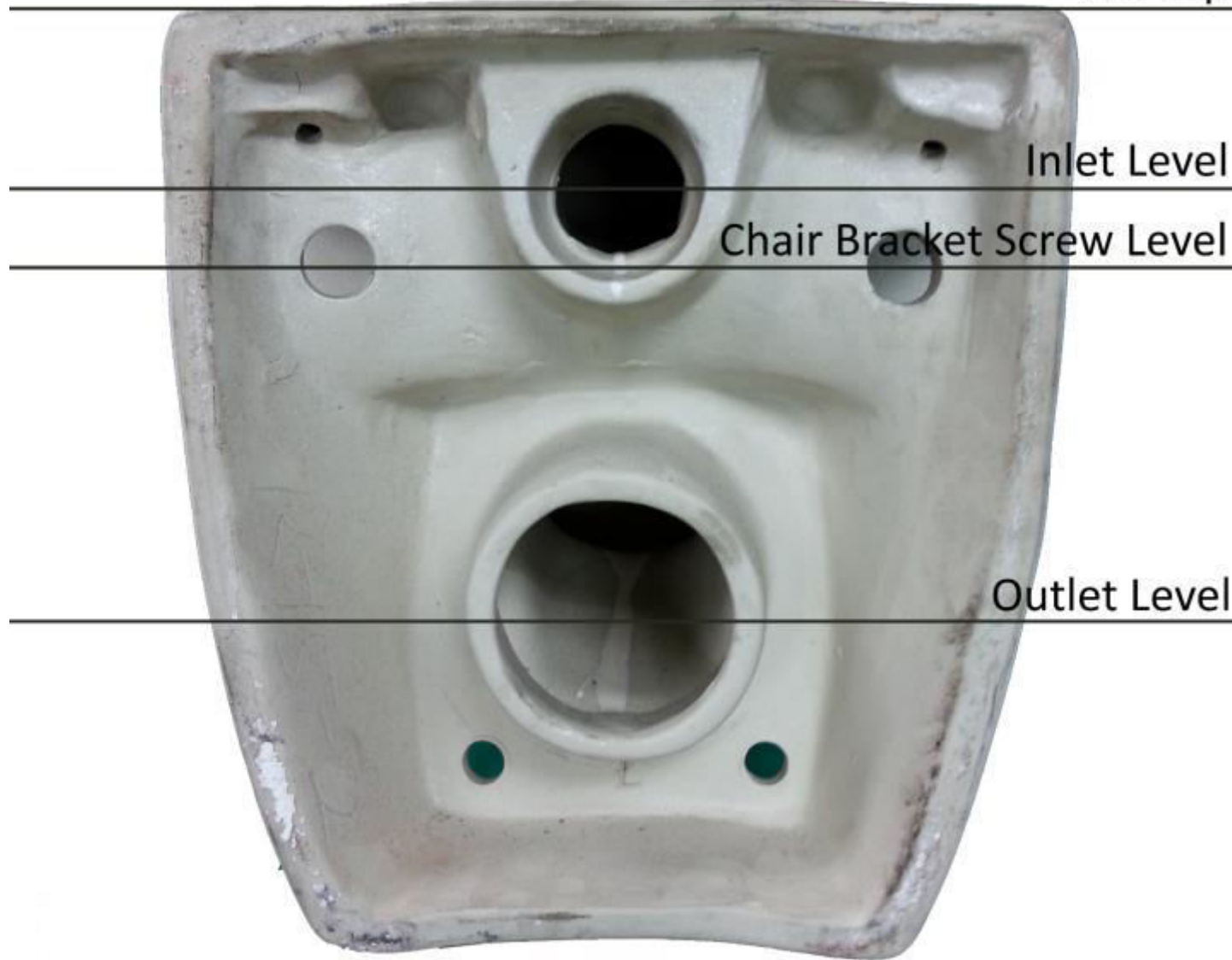

Step 1:

Remove Temporary Cover from
Actuator Bracket

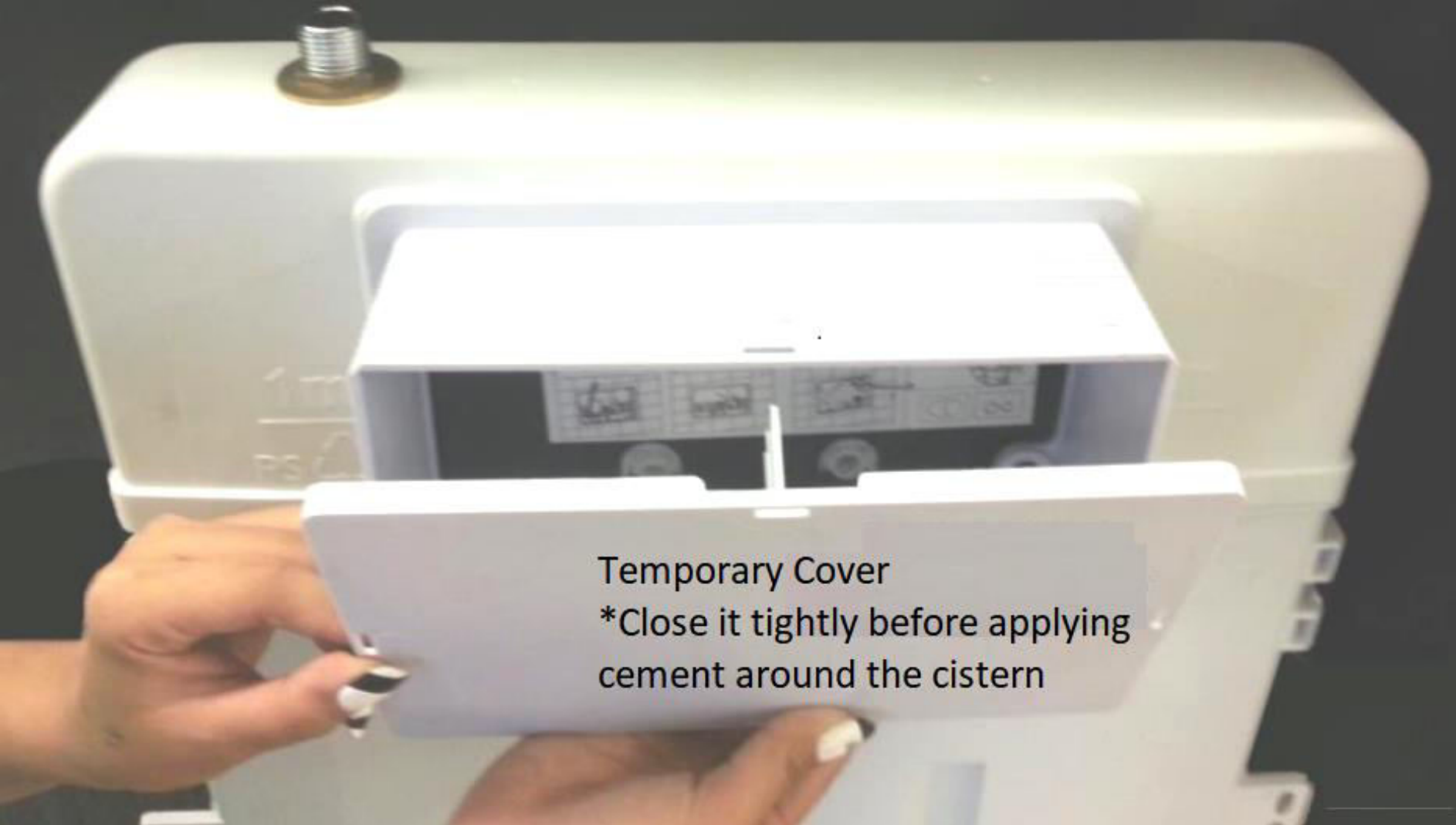

Step 2:

Determine the length of Actuator Bracket (according to the level of wall)



Remove temporary cover, measure cement and tile thickness, cut away a few layers of Actuator Bracket if necessary.

Step 3:

Install the Adjusting Rod onto Actuator Bracket

Make sure the Button Rod Slots are in correct position i.e. longer end facing inside.

Adjusting Rod

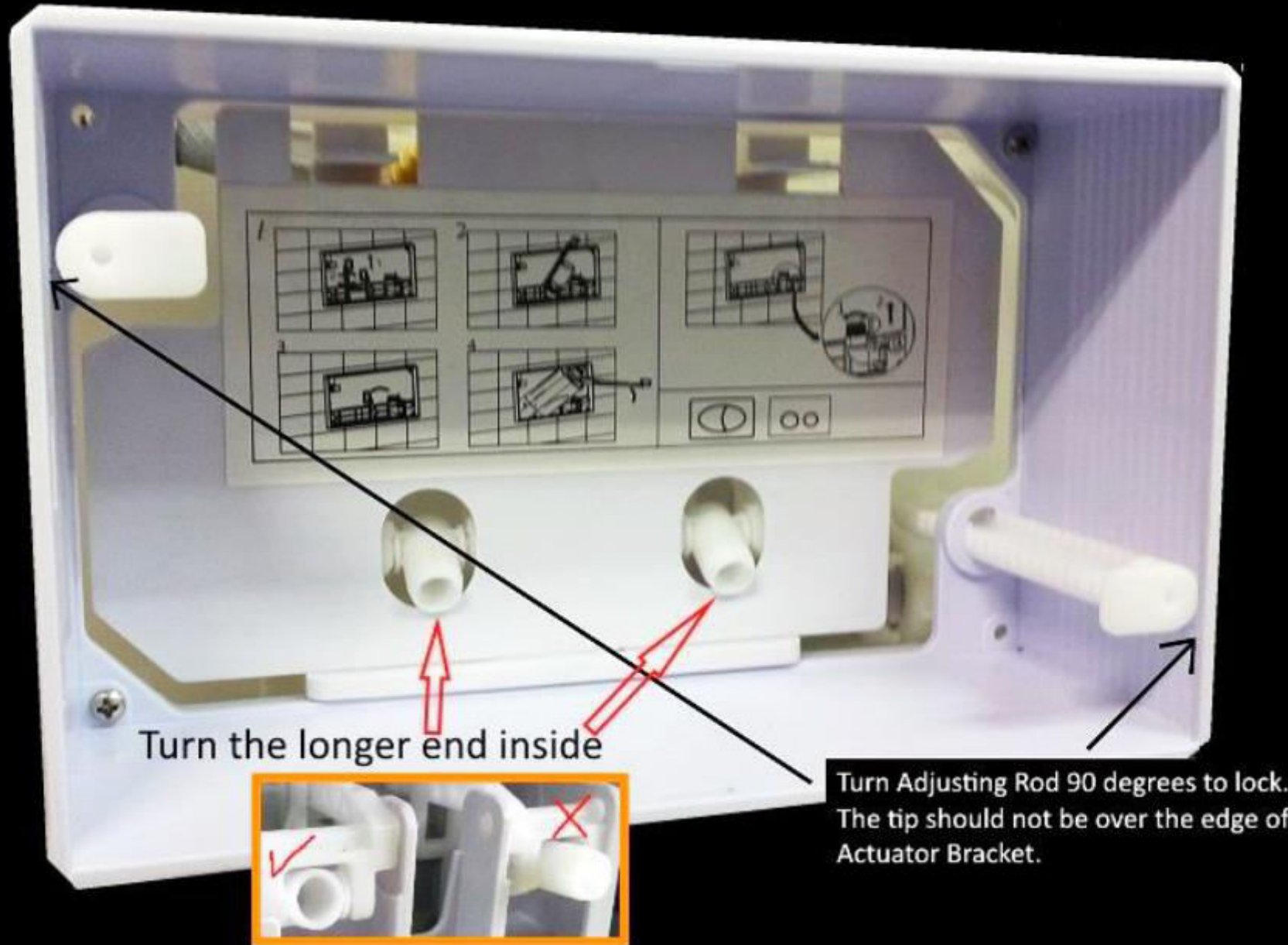

Turn the longer end inside

Turn Adjusting Rod 90 degrees to lock.
The tip should not be over the edge of
Actuator Bracket.

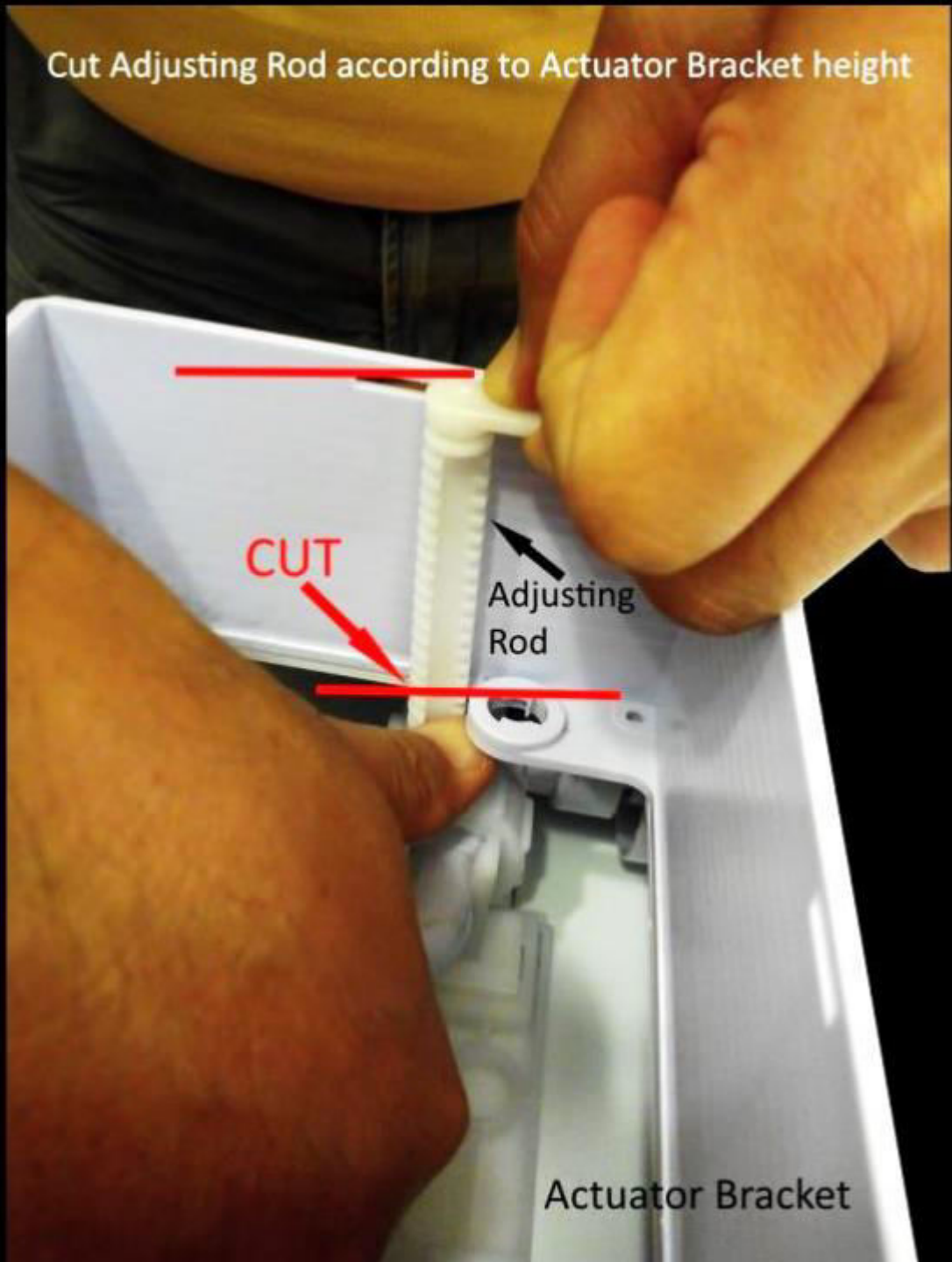

Step 3

(cont'd):

Install the Adjusting Rod onto Actuator Bracket

Note: The “head” of Adjusting Rod should be on par or slightly recessed from Actuator Bracket (must not protrude out of the Actuator Bracket)

Important Note:

Turn clock-wise to insert Button Rod. Fine tune the length to allow chromed buttons on Actuator a little bit (2-3mm) of buffer space when pressed lightly. Caution: Totally no buffer will lead to leaking; Too much buffer will lead to difficulty in effective flushing.

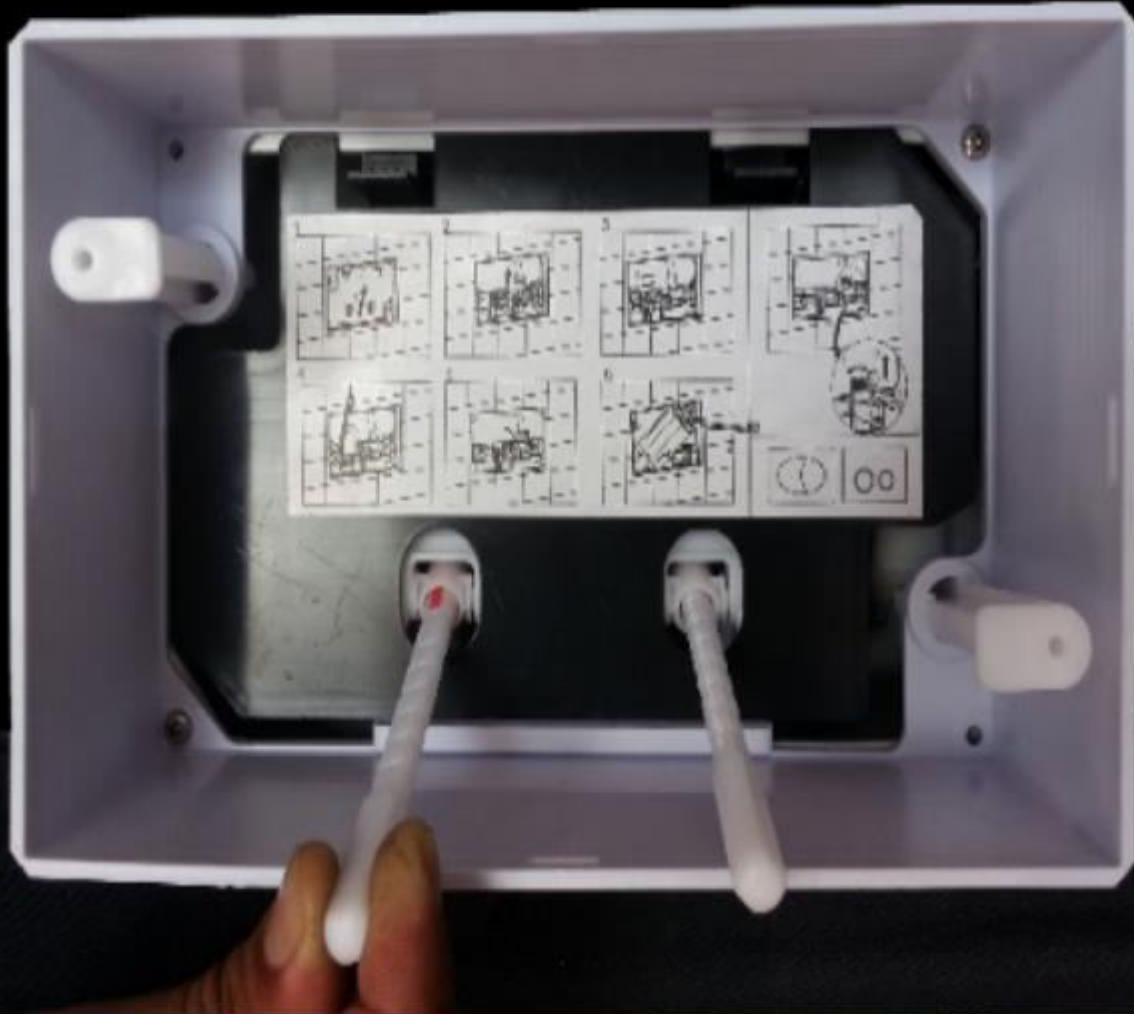

Step 4:

Install the two Button Rods onto their slots

Make sure the Button Rod Slots are in correct position i.e. longer end facing inside.

Step 4 (cont'd):

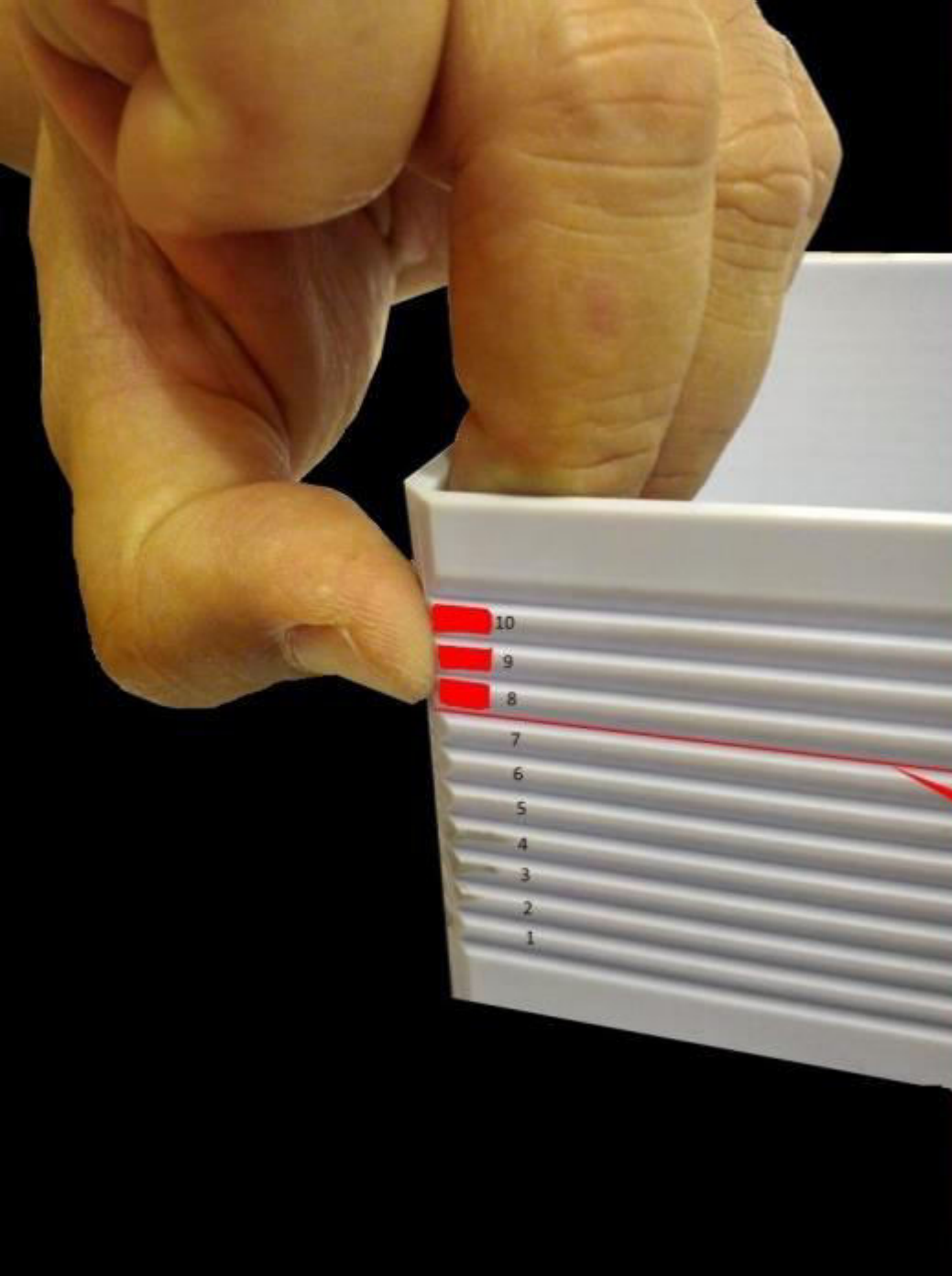

If you cut Level 10, 9 or 8 ONLY
(Not More Than 3 Levels)

**DO NOT CUT
Button Rod.**



Button Rod

If Cut Lower Than This Line

please CUT OFF the last section
of Button Rod. →



Step 5:

Install Button Panel by tightening one screw each onto the head of the two Adjusting Rods.

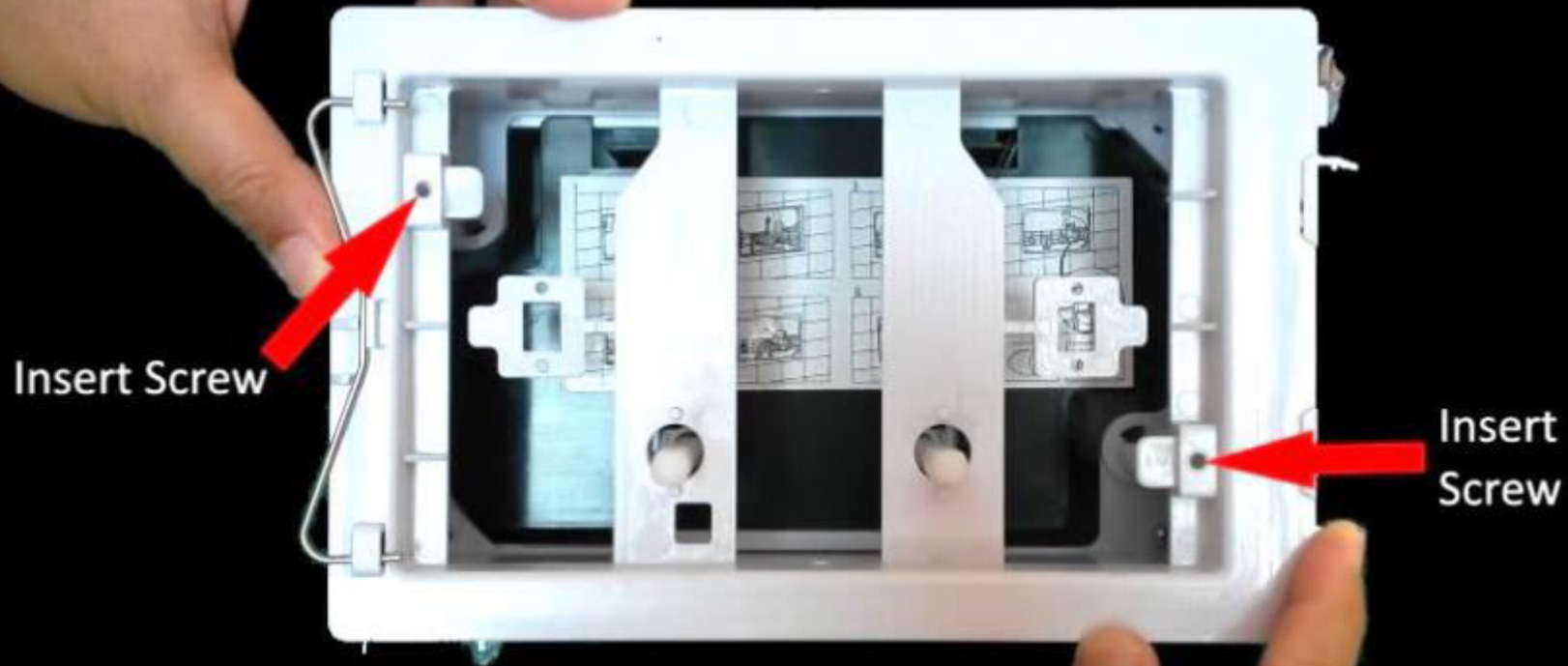



Step 6:

After the Button Rod is adjusted to proper length, break the Square Guide Plate from Button Panel, and snap it over the round hole (The guide plate is to guide movement of rod and to prevent the rod from turning).



Put on Button Plate

Press against spring

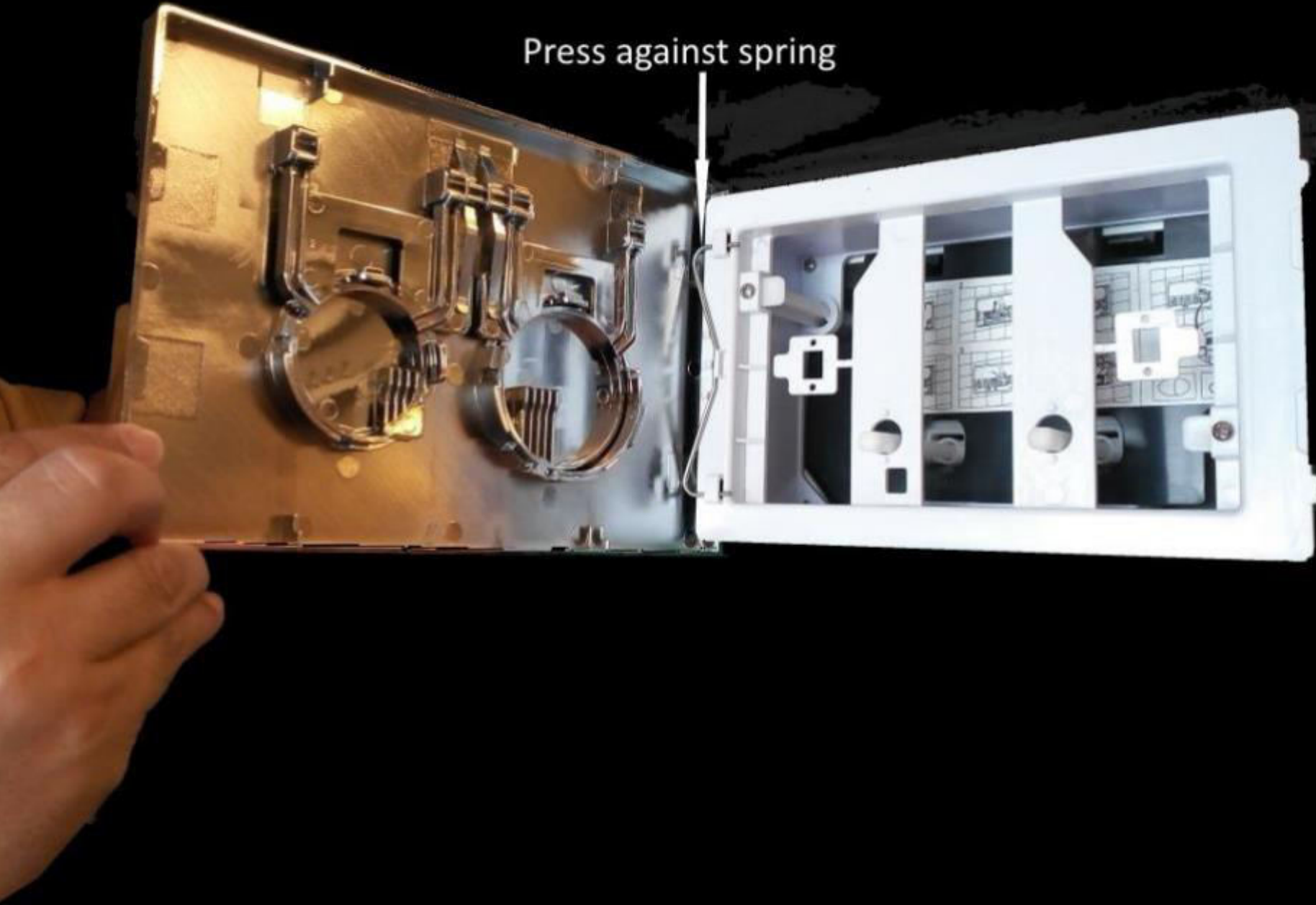

Step 7:

Install Button Plate onto Button Panel by pressing the left side of Button Plate against the spring on Button Panel.

Swing to close.

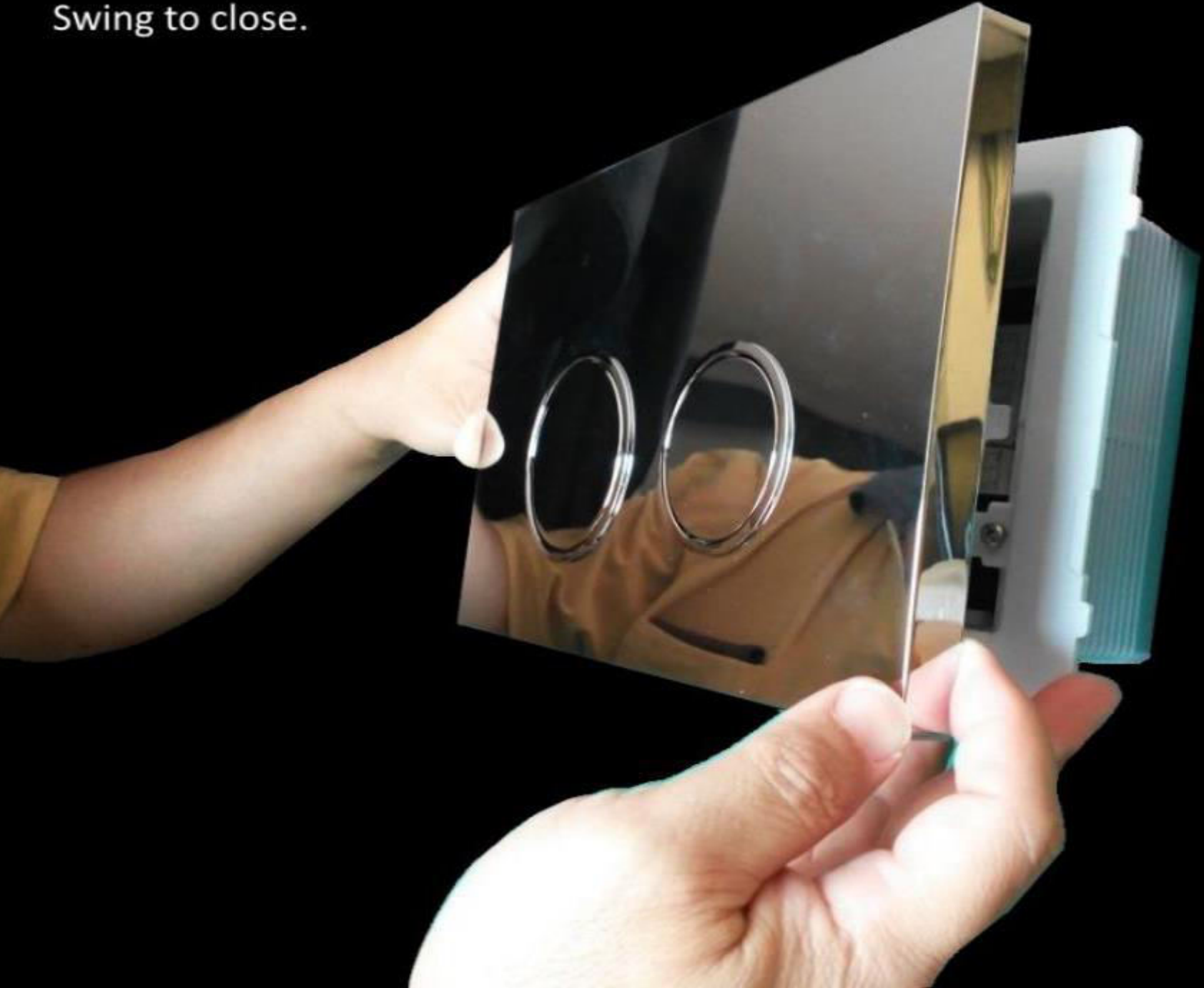

Step 7
(cont'd):



THANK YOU!