

# Coil Cleaning Machine

## PCW-4P/4Li PCW-4W/4WLi -Operation Manual



### 1.INTRODUCTION

Thank you for purchasing our PCW Series coil cleaning machines. This user manual is meant to offer you a brief walkthrough of the device's features and usage protocols. We hope you find this manual helpful. For additional information and technical support, please feel encouraged to contact your local distributor

### 2.INTENDED USAGE

The PCW series coil cleaning machines is a complete and independent cleaning solution in one small, portable unit. And they have 2 versions for your choice, AC power supply (powered by a wall plug) or 18V Li-ion power supply. They are professional machines which intended for HVAC coil cleaning with efficient but safety for coils. But they are also can be used for vehicle cleaning, household cleaning and so on.

### 3.BOX CONTENTS

#### PCW-4P

1.Coil cleaning machine	2.Spray Gun
3,0° pin point nozzle	4,220° rotational nozzle
5,3pin Power Cord	6,1x37cm extension wand
7,2,5m inlet hose	8,5m outlet hose

#### PCW-4Li

1.Coil cleaning machine	2.Spray Gun
3,0° pin point nozzle	4,220° rotational nozzle
5,1x37cm extension wand	6,2,5m inlet hose
7,5m outlet hose	

#### PCW-4W

1.Coil cleaning machine	2.Spray Gun
3,0° pin point nozzle	4,220° rotational nozzle
5,5m outlet hose	6,1x37cm extension wand

#### PCW-4WLi

1.Coil cleaning machine	2.Spray Gun
3,0° pin point nozzle	4,220° rotational nozzle
5,5m outlet hose	6,1x37cm extension wand

Adaptor: (Optional)	<input type="radio"/> Bosch	<input type="radio"/> Makita
	<input type="radio"/> Panasonic	<input type="radio"/> Milwaukee
	<input type="radio"/> Worx	<input type="radio"/> DeWalt

Operation Manual 01

### 4.PARTS

#### PCW-4P/PCW-4Li

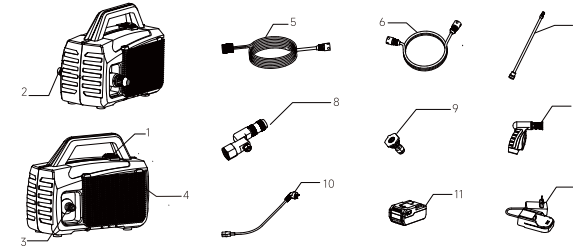

1. Switch	8. 220°rotational nozzle
2. Inlet	9. 0°pinpoint nozzle
3. Outlet	10. 3pin Power Cord(PCW-4P)
4. Mesh Storage Compartment	11. 18V-Lion Battery(PCW-4Li,Optional)
5. Inlet hose(2,5M)	12. Battery Charger(PCW-4Li,Optional)
6. Outlet hose(5M)	13. Spray Gun
7. Extension wand(37cm)	

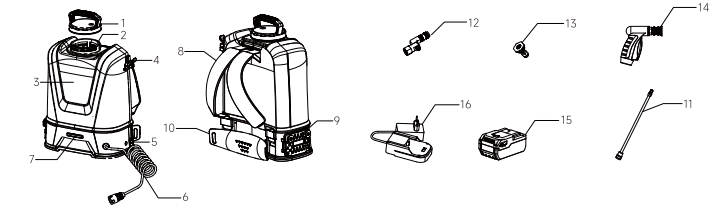

1. Tank cover	9. Storage Cover
2. Filter	10. Lumbar support
3. Water tank	11. Extension wand(37cm)
4. Storage Hook	12. 220°rotational nozzle
5. Power Switch	13. 0°pinpoint nozzle
6. Outlet hose(5M)	14. Spray Gun
7. LED light	15. 18V-Lion Battery(Optional)
8. Back Strap	16. Battery Charger(Optional)

Operation Manual 02

### 5.TECHNICAL SPECIFICATIONS

Model	PCW-4P	PCW-4Li	PCW-4W	PCW-4WLi
Voltage	230V/50-60Hz 110V/50-60Hz	18V	230V/50-60Hz 110V/50-60Hz	18V
Working Pressure	5/10Bar			
Flowrate	4L/min			
Water Tank				16L

### 6.SAFETY INFORMATION

The information contained in this section is provided for your own safety and the safety of others. Please be sure to read this manual carefully and use the appliance in accordance with these instructions. Keep the manual in a safe place for future reference.



**CAUTION**  
Do not operate this machine without eye protection.

- Do not use any liquid other than clean water.
- Use water of temperature between 0°C and 50°C only.
- Do not leave appliance plugged in or battery in when not in use.
- This is not a toy. Exercise extra care when using near children.
- Do not spray water directly at eyes or mouth.
- Do not direct water jet at unit itself or other electrical equipment.
- Use only manufacturer's recommended accessories and parts.
- Always use plug/amp fuse recommended for this appliance.
- Do not use with damaged battery, cord or plug.
- Do not use if damaged or dropped into water.
- Keep cord away from heated surfaces, and Do not pull or carry by cord.
- Keep nozzle free of obstructing objects. Do not use with clogged nozzle.
- Keep hair, loose clothing and all parts of body away from moving machine parts.
- Do not use appliance without a water filter in place.
- Turn off all controls before unplugging.
- To avoid damage and injury, use proper voltage only.
- Do not alter nozzle head's original diameter.
- Discharge residual pressure and water before disconnecting hose.
- Check for broken or worn parts before each use.
- Never submerge appliance in water.
- Do not allow unit to freeze. Always empty tank and inside water and store unit indoors.
- Do not remove cover plate or attempt to disassemble appliance.
- Replace damaged hose immediately. Otherwise, hose may burst and potentially cause serious injury.

Operation Manual 03

### 7. OPERATION STEPS

#### PCW-4P/PCW-4Li

\* Note:  
The machines has the fuction of self-suction, so it can pump water from the water tank or connected directly with tap water



Operation Manual 04

#### PCW-4W/PCW-4WLi

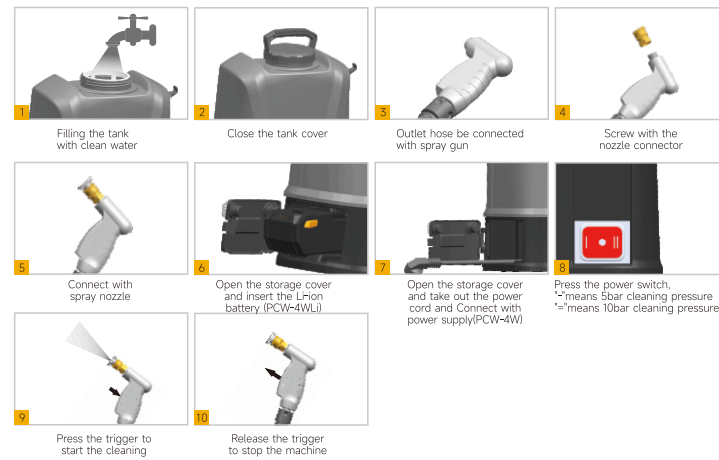

#### EXTENSION WAND USAGE



#### LI-ION BATTERY'S CHARGE



Note: Check the battery level before each usage.  
The led indicator light will be flashed when in low level

Operation Manual 05

### Air Purging:

With normal use, air can get trapped in the washer's hose. We recommend the following steps to purge the air out of the system and achieve maximum washing pressure:

1. Power up your Cleaning machine.
2. Point the Spray Gun into the water tank and squeeze the lever until the water stream steadies.
3. Start to enjoy your cleaning works

### 8. TROUBLESHOOTING

PROBLEM	PROBABLE CAUSE	REMEDY
Pump can't start	• Li-ion battery power not enough <small>(PCW-4Li/PCW-4WLi)</small>	• Check battery and charge in time
	• No AC power supply(PCW-4P/PCW-4W)	• Check the power supply, make the connection tight
	• AC voltage is not correct <small>(PCW-4P/PCW-4W)</small>	• Make sure the input voltage within rated voltage ±5%
Inconsistent and/or erratic pressure	• Temperature is too low(<0°C)	• Increase ambient temperature
	• Nozzle worn	• Replace nozzle
	• Nozzle clogged	• Clean nozzle orifice
	• Water is low	• Add water
"Motor continues to run even though trigger isreleased"	• Air sucked into system	• Fill water
	• Air in pump (not properly primed)	• Remove nozzle, prime pump
	• Vacuum lock (cap vent clogged) <small>(PCW-4P/PCW-4W)</small>	• Clean cap air vent
	• Water temp too high	• Add cold water to reduce temp
"Motor stops abruptly"	• Low battery <small>(PCW-4Li/PCW-4WLi)</small>	• Charge or replace battery
	• High pressure system or pump hydraulic circuit not watertight	• Check for leaks at spray gun and pump
	• Air in system	• Re-prime the unit
	• Tank(s) empty <small>(PCW-4Li/PCW-4WLi)</small>	• Fill tank(s)
"Motor buzzes but fails to start or does not start at all"	• Low battery power <small>(PCW-4Li/PCW-4WLi)</small>	• Charge or replace battery
	• Power plug loosen <small>(PCW-4P/PCW-4W)</small>	• Plug again
	• Power switch off	• Turn switch on
	• Thermal breaker tripped	• Turn off, let unit cool
"No water flow/ Water not priming"	• Problems with pump auto shut-off	• Contact seller
	• Unit in disuse for extended time	• Contact seller
	• Pressure needs to be relieved	• Squeeze trigger and relieve pressure
	• The water inlet is blocked	• Clean the inlet filter
	• There is impurities inside	• Remove the internal impurities

Operation Manual 06

### 9. MORE PRODUCTS FOR YOUR CHOICE



Model	PCW-6T
Voltage	100-120V-50-60Hz 230V-/50-60Hz
Power	750W
Working Pressure	10-40Bar(145-580psi)
Flowrate	6L/min
Weight	8,0KGS

Adjustable high pressure cleaning machine(PCW-6T)



Model	PCW-3V
Voltage	100-120V-50-60Hz 230V-/50-60Hz
Power	3300W/2200W
Steam Pressure	6bar/4bar
Steam Temp.	130°C-150°C
Flowrate	3L/min
Weight	6,0KGS

Steam Cleaning Machine(PCW-3V)

Operation Manual 07