

INDUCTION MOTOR

MEISTER Series

LEAD WIRE TYPE

60□ **6w**

IH 1PHASE 4POLE

■ PERFORMANCE DATA (DUTY : CONTINUOUS)

Motor Type	Output (W)	Voltage (V)	Freq. (Hz)	Rating				Stating	Condenser	
				Input (W)	Current (mA)	Torque (gf·cm)	Speed (rpm)	Torque (gf·cm)	(V)	(μF)
IH6PF6-10	6	1φ100	50	30	300	450	1250	450	250	2.5
			60	30	300	370	1550	450		
IH6PF6-11	6	1φ110	60	30	300	370	1550	450	250	2.5
IH6PF6-20	6	1φ200	50	30	160	450	1250	450	450	0.7
			60	30	160	370	1550	450		
IH6PF6-22	6	1φ220	60	30	160	370	1550	450	450	0.7
IH6PF6-1U	6	1φ100	50	30	300	450	1250	450	250	2.5
			60	30	300	370	1550	450		
IH6PF6-2C	6	1φ220	50	30	160	310	1250	500	450	0.6
		1φ240	50	35	160	390	1250	600		

- Motor Type은 감속기 직결용인 피니언축으로 표시하였습니다. STRAIGHT축의 모터를 희망하시면 Motor Type의 PF를 S로 바꾸어 주문하십시오.
- 표시한 모터는 UL 또는 CE규격을 적용한 TP(Thermal Protect) Type입니다.
- For motor with straight shaft, please write S in place of PF in Motor Type.
- Motor Type in green screen represents the motors with TP(Thermal Protect) according to UL or CE regulation.

■ RATED TORQUE OF GEARED MOTOR

(unit : kg·cm)

Speed of Geared Motor	rpm	500	300	200	120	100	60	50	30	20	15	10
Gear Ratio	50Hz	3	5	7.5	12.5	15	25	30	50	75	100	150
	60Hz	3.6	6	9	15	18	30	36	60	90	120	180
IH6PF6 + 6H□FM		1.1	1.9	2.7	4.5	5.4	8.8	11	17	24	25	25
IH6PF6 + 6H□FB		1.1	1.9	2.7	4.5	5.4	8.8	11	17	24	25	25

- 표시한 감속비의 감속기는 출력축의 회전방향이 모터축의 회전방향과 반대로 됩니다.
- 감속모터의 회전수(Speed of Geared Motor)는 모터의 회전수 (50Hz에서 1500rpm, 60Hz에서 1800rpm)를 기준하여 산출하였습니다. 실사용시의 회전수는 부하의 크기에 따라 위의 표보다 2~15% 작게 됩니다.
- □부에는 감속비를 지정하여 주십시오. 감속기는 별도로 판매 됩니다.
- The rotation of geared motor in green screen is reverse of motor rotation.
- Speed of Geared Motor is based on motor synchronous speed. In normal operation, the speed will be 2 to 15 percent lower than above figure.
- When ordering gear head, please fill blank □ with gear ratio.

OUTLINE DIMENSION



Fig.1 MOTOR(STRAIGHT SHAFT) IH6S6 WT 1.0kg

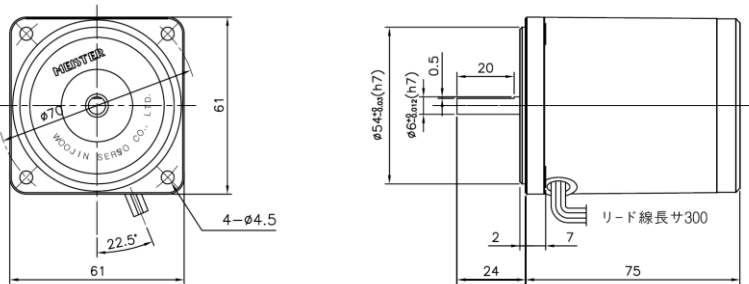
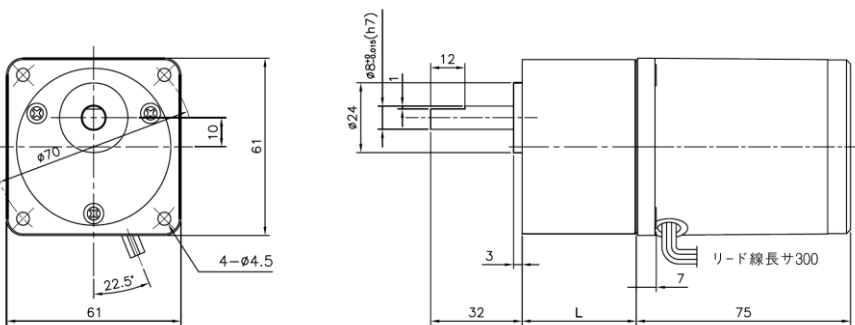
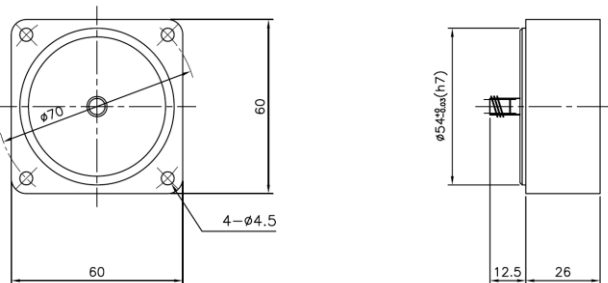

Fig.2 GEARED MOTOR IH6PF6 + 6H□FM(6H□FB) WT 1.0 + 0.4 kg



No	L(mm)	減速比	ボルト
01	30	1/3 ~ 1/18	M4 × 60
02	40	1/20 ~ 1/200	M4 × 70

Fig.3 DECIMAL GEAR HEAD 6H10X WT 0.17 kg



WIRING DIAGRAM

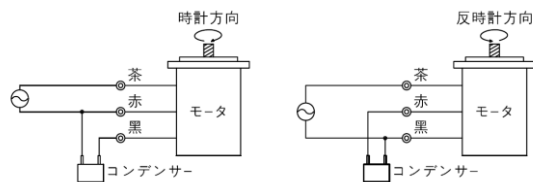

- ・ 회전방향은 모터의 샤프트 끝 쪽에서 볼 때의 회전방향 입니다.
- ・ The direction of rotation is seen from the end of motor shaft.