

# **Elitech RCW-800W-TDE Wireless** **Temperature Data Logger – 2 External** **Temperature Sensors**

Elitech RCW-800W-TDE wireless temperature data logger has double temperature sensors. With a built-in rechargeable lithium battery, it can provide real-time data uploading and platform alarm service even in case of cold storage power outage.

Export data flexibly in multiple formats via the cloud platform.

## **Wireless Monitoring**

No Gateway, no monthly registration fee, 24/7 real-time monitoring

## **Easy WiFi Setting, 3 Steps to set up**

- Add device via Elitech APP
- Connect 600WIFI network
- Go to 192.168.2.1 to complete the Wifi setting as instructed on user manual
- Notice: the reset button is on the back to help reconnect to network.

## **iOS and Android App**

- Support iOS and Android system
- Rich operation functions: settable parameters, traceable device status, data management or export

## **Push Notification & Alert**

Email alerts and audible & visual alarm for excessive temperature or low power, etc. Push time is settable to help user monitor the device any time.

## **Offline Record**

- Run up to 6 hours
- Record 20000 points of data, with no data storage limit in server when device is offline.
- Upload offline data automatically when connecting to network
- Besides Elitech App, Elitech Cloud Portal is accessible to any browser.
- More setting up and management can be achieved once.

## **Multiple Cloud Services**

Standard plan (free) provides email alert, remote setting, and 30 days data review and storage; Advanced and professional plan available, which provide 3~5 years data storage, data export, user management, and FDA service.

## Specification:

Model: RCW-800W-TDE

- ◆Communication method: WIFI
- ◆Channel: external dual temperature
- ◆Temperature range: -40°C~80°C
- ◆Temperature accuracy:  $\pm 0.5^{\circ}\text{C}$  (-20°C~40°C)  $\pm 1^{\circ}\text{C}$  (others)
- ◆Resolution: Temperature: 0.1°C
- ◆Storage capacity: 20000 groups
- ◆Recording interval: 1 minute to 24 hours,
- ◆Alarm type: buzzer, indicator light
- ◆Battery life: no less than 7 days
- ◆Alarm mode: SMS, WeChat, APP, email push
- ◆Display: TFT color screen
- ◆Power supply method: Power adapter: 5V/1A(DC)
- ◆Battery capacity: 2000mAH
- ◆Configure magnet adsorption mounting bracket



Elitech®

*Innovation Preceding All*

## Remote Temperature & Humidity Monitoring



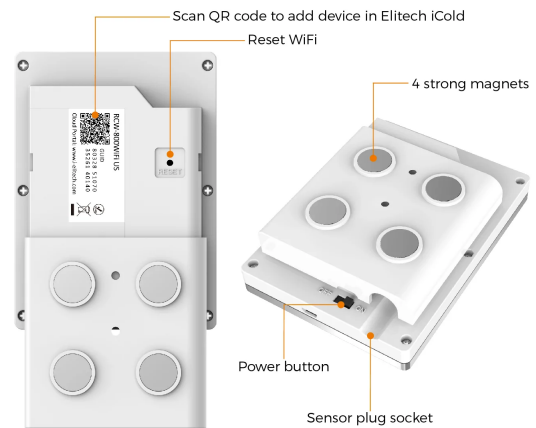
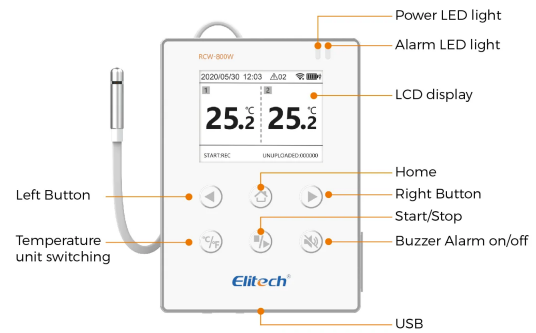
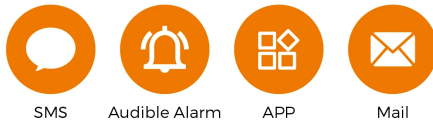
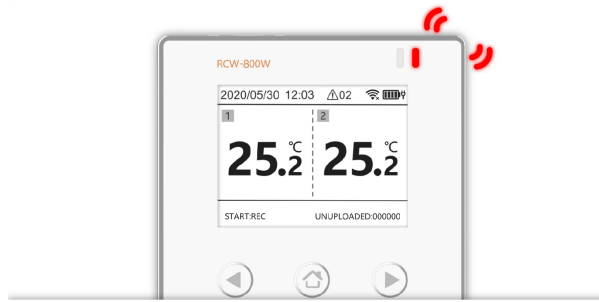

Function Privileges	Basic services STD	Premium service ADV	Exclusive service PRO
Real-time data viewing	√	√	√
Remote real-time alarm (Email & App & Cloud&Sms)*	√	√	√
Data query and export	30 days	3 years	5 years
location service*	X	√	300
SMS quantity	X	50	√
Early warning function	X	X	√
Multi-level alarm	X	√	√
FDA21 CFR Compliant	X	X	√
traffic cost	√	√	√

Ordered  
Free Service

Buy Now  
\$19.98/y

Buy Now  
\$39.96/y

