



## SIMPLE & RELIABLE

Protect your employees

### BoTEMP-Y

#### Automated Body Temperature Reader



BoTemp-Y is an automated Smart Body Temperature Reader made receptive to a 5 to 10 cm distance body temperature sensing through palm reading. This reader is a modest design that comes with an affordable price, delivering its service with easy integration with biometrics and card readers.

TimeTec BoTemp-Y is unique as it can work as a standalone reader relay interface, or it can function as a plug-and-play solution to biometric devices. Acquiring the most economical option and accommodating user's comfort by its efficiency to combat the pandemic.

*Suitable for retail stores, restaurants, offices, schools, shopping malls, hospitals, all types of premises.*



**No Contact**  
Avoid cross-contamination



**Fully Automated**  
No manpower required,  
save cost



**Fast reading**  
Detect accurate body  
temperature in seconds



**Accuracy**  
Get precise body  
temperature despite the  
surrounding heat



**Long-range**  
Accurate reading between  
5-10cm from the palm



**Alert**  
Set alarm siren off  
whenever the feverish  
temperature is detected



**Temperature Display**  
View the temperature  
reading from the LED



**Easy integration**  
Connect it to any devices  
as temperature reader



**Easy installation**  
Wall mounted beside the  
existing reader or  
standalone



# SYSTEM DIAGRAM

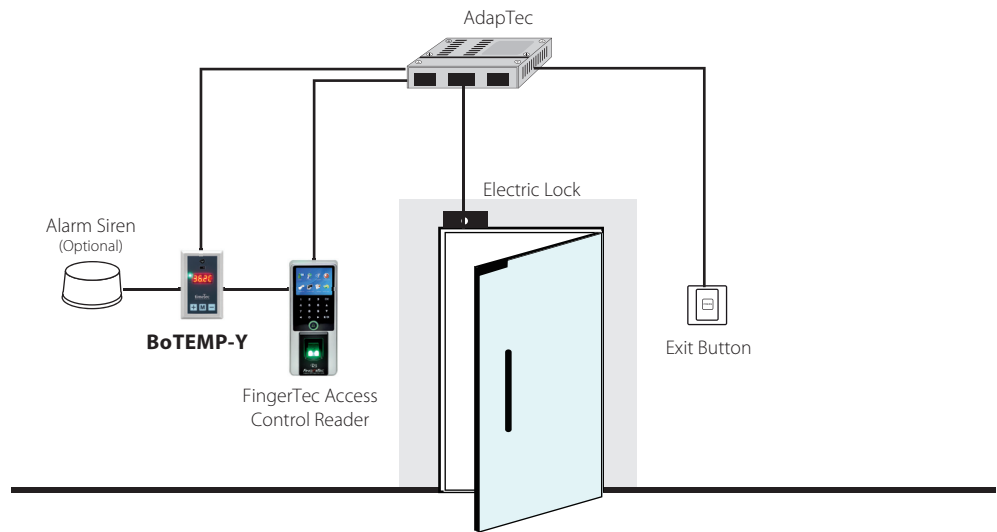

## SPECIFICATIONS



MODEL	BoTEMP-Y
PRODUCT DIMENSION (mm)	120 x 100 x 22
WEIGHT (gm)	200
MEASURING DISTANCE (cm)	5 - 10
MEASURING TIME (second)	<0.5
SENSOR	WTT5001
ACCURACY	+/-0.2°C
WORKING AMBIENT TEMPERATURE	5°C ~ 44°C
MEASURED TEMPERATURE RANGE	35°C ~ 42.9°C
DISPLAY	Infrared LED
OPERATING VOLTAGE	5V-12V DC
INTERNAL RELAY	Yes
ALARM	Yes (external available), 5V-12V Output
CERTIFICATE	CE/FCC
INSTALLATION	Wall-mounted

**FINGERTEC**

Compatible with FingerTec models

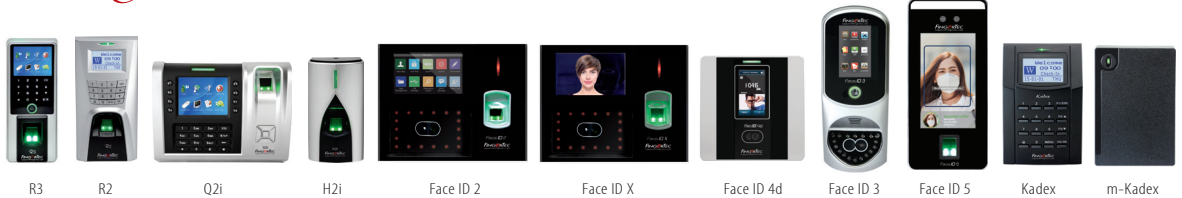

**Note:** Specifications are subject to change without prior notice.

Authorized Reseller: