

PowerMaxx ASE SSE 18 LTX Compact

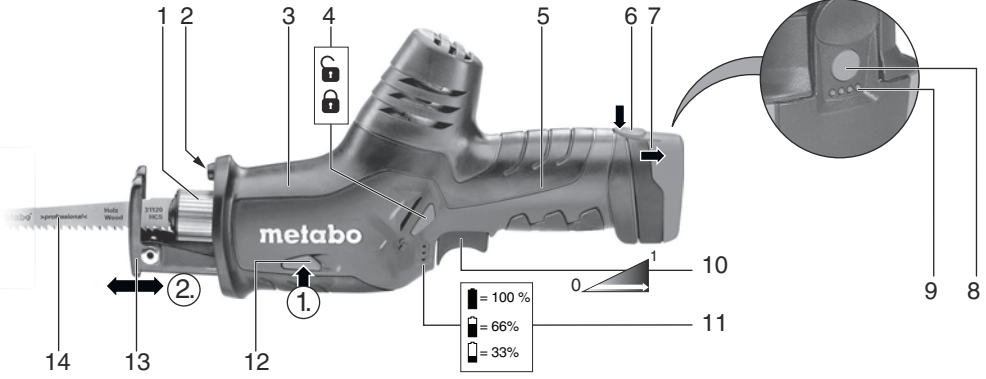

de	Originalbetriebsanleitung	5	fi	Alkuperäinen käyttöopas	37
en	Original instructions	9	no	Original bruksanvisning	41
fr	Notice d'utilisation originale	13	da	Original brugsanvisning	45
nl	Originele gebruiksaanwijzing	17	pl	Instrukcja oryginalna	49
it	Istruzioni per l'uso originali	21	el	Πρωτότυπο οδηγιών χρήσης	54
es	Manual original	25	hu	Eredeti használati utasítás	59
pt	Manual original	29	ru	Оригинальное руководство по эксплуатации	63
sv	Originalbruksanvisning	33			

PowerMaxx ASE



SSE 18 LTX Compact

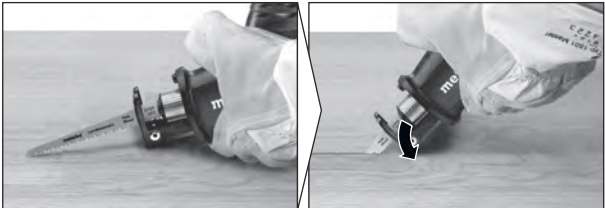
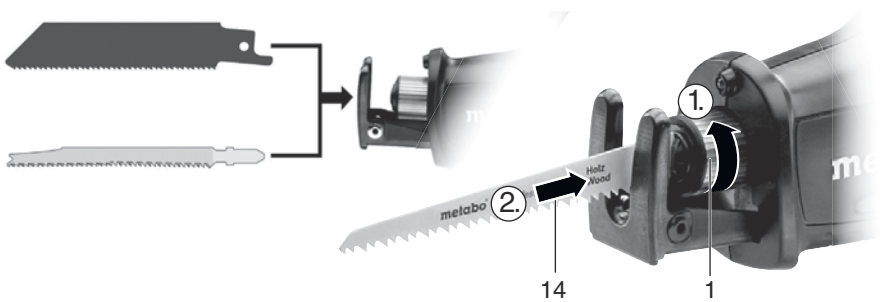
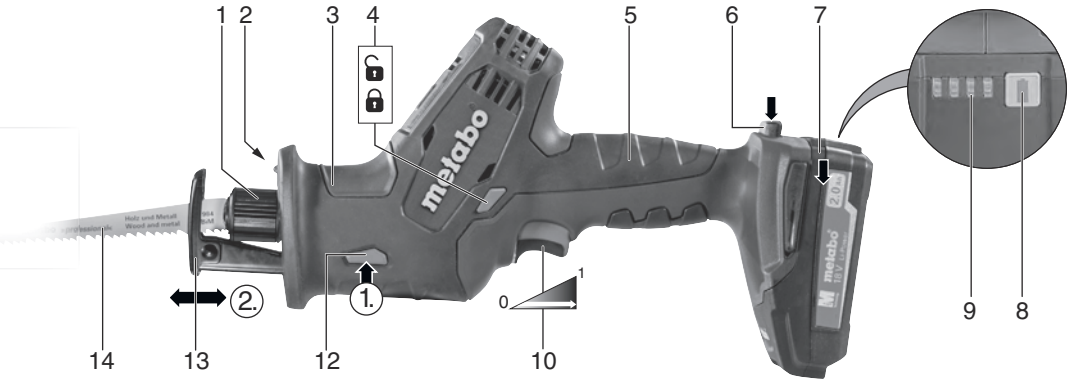

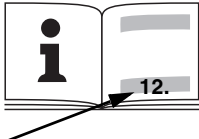
		PowerMaxx ASE *1) Serial Number: 02264..	SSE 18 LTX Compact *1) Serial Number: 02266..
U	V	10,8	18
n₀	/min (spm)	0 - 3100	0 - 3100
s	mm (in)	13 (1/2)	13 (1/2)
m	kg (lbs)	1,2 (2.6)	1,7 (3.7)
a_{h, B}/K_{h, B}	m/s²	7 / 1,5	10 / 1,5
a_{h, WB}/K_{h, WB}	m/s²	- / -	9 / 1,5
L_{pA}/K_{pA}	dB(A)	79 / 3	80 / 3
L_{WA}/K_{WA}	dB(A)	90 / 3	91 / 3

CE *2) 2014/30/EU, 2006/42/EC, 2011/65/EU
*3) EN 60745-1:2009+A11:2010, EN 60745-2-11:2010, EN 50581:2012

2016-10-01, Bernd Fleischmann *i.v. B. F.*
Direktor Produktentstehung & Qualität (Vice President Product Engineering & Quality)
*4) Metabowerke GmbH - Metabo-Allee 1 - 72622 Nuertingen, Germany

Mögliches Zubehör - Possible accessories - Accessoires possibles - Mogelijke toebehoren - Accessori possibili - Accesorios disponibles - Acessórios possíveis - Tillgängliga tillbehör - Mahdolliset lisätarvikkeet - Mulig tilbehør - Muligt tilbehør - Dopuszczalne akcesoria - Διαθέσιμα εξαρτήματα - Lehetséges tartozék - Возможные принадлежности



(A)

(B)

PowerMaxx ASE:



LC 40

SSE 18 LTX Compact:



ASC 30-36 V



ASC ultra

etc.

(C)

PowerMaxx ASE:



10,8 V	1,5 Ah	6.25439	Li-Power
10,8 V	3,0 Ah	6.25436	Li-Power
10,8 V	4,0 Ah	6.25585	Li-Power
etc.			

SSE 18 LTX Compact:



18 V	2,0 Ah	6.25596	Li-Power
18 V	4,0 Ah	6.25591	Li-Power
18 V	5,2 Ah	6.25592	Li-Power
etc.			

(D)



6.23443

Zubehör nicht im Lieferumfang enthalten - Accessories not included in scope of delivery - Accessoires non fournis - Toebehoren niet bij de levering inbegrepen - Accessori non compresi in dotazione - Accesorios no incluidos en el suministro de serie - Acessórios não incluídos no volume de fornecimento - Tillbehör ingår inte - Lisätarvikkeet eivät kuulu toimitussisältöön - Tilbehør er ikke inkludert - Tilbehør er ikke inkluderet i leveringsomfanget - Akcesoria nie objęte zakresem dostawy - Τα εξαρτήματα δε συμπεριλαμβάνονται στα υλικά παράδοσης - A tartozék nem képezi a szállítmány részét - Принадлежности не входят в комплект поставки

Original instructions

1. Declaration of Conformity

We declare under our sole responsibility: These cordless sabre saws, identified by type and serial number *1), comply with all relevant requirements of the directives *2) and standards *3). Technical file at *4) - see page 3.

2. Specified Use

The tool is suitable for sawing wood, metals, plastics or similar materials such as hard rubber, fibre glass, etc.

The user bears sole responsibility for any damage caused by improper use.

Generally accepted accident prevention regulations and the enclosed safety information must be observed.

3. General Safety Instructions



For your own protection and for the protection of your power tool, pay attention to all parts of the text that are marked with this symbol!



WARNING – Reading the operating instructions will reduce the risk of injury.



WARNING Read all safety warnings and instructions. Failure to follow all safety warnings and instructions may result in electric shock, fire and/or serious injury.

Keep all safety instructions and information for future reference.

Pass on your electrical tool only together with these documents.

4. Special Safety Instructions

Hold power tool by insulated gripping surfaces, when performing an operation where the cutting accessory may contact hidden wiring. Cutting accessory contacting a "live" wire may make exposed metal parts of the electrical tool "live" and could give the operator an electric shock.

When not in use, lock the machine with the switch-on lock (4) to prevent it from switching on inadvertently.

Remove the battery pack from the machine before any adjustments, conversions, servicing or cleaning are performed.

Before fitting the battery pack, make sure that the machine is switched off.

Always wear protective goggles, gloves, and sturdy shoes when working with this tool.

Ensure that the spot where you wish to work is free of **power cables, gas lines or water pipes** (e.g. using a metal detector).

When sawing water pipes, ensure that they do not contain any water.

Wear ear protectors when working for long periods of time. High noise levels over a prolonged period of time may affect your hearing.

Materials that generate dusts or vapours that may be harmful to health (e.g. asbestos) must not be processed.

Do not try to saw extremely small workpieces.

Clamp the workpiece firmly. Under no circumstances should you hold the workpiece with your hand or foot.

Only use sharp, undamaged saw blades. Do not use any cracked saw blades or blades that have changed their shape.

Only use the machine with the guide fitted. For sawing, the guide must make secure contact with the workpiece.

Always hold the machine with both hands using the handles provided, stand securely and concentrate.

Danger of injury due to the sharp saw blade.

Do not touch the moving saw blade! Remove chips and similar material only with the machine at standstill.

Do not reach under the workpiece while the machine is in operation.

Risk of crushing during operation! Keep your fingers away from the area of the saw blade tensioning device (2).

LED working light (2): Do not observe the LED radiation directly with optical instruments.



Protect battery packs from water and moisture!



Do not expose battery packs to naked flame!

Do not use faulty or deformed battery packs!

Do not open battery packs!

Do not touch or short-circuit battery packs!



Slightly acidic, flammable fluid may leak from defective li-ion battery packs!



If battery fluid leaks out and comes into contact with your skin, rinse immediately with plenty of water. If battery fluid leaks out and comes into contact with your eyes, wash them with clean water and seek medical attention immediately.

If the machine is defective, remove the battery pack from the machine.

Reducing dust exposure:



Some of the dust created using this power tool may contain chemicals known to cause cancer, allergic reaction, respiratory disease, birth defects or other reproductive harm. Some of these substances include: lead (in paint containing lead), mineral dust (from bricks, concrete etc.), additives used for wood treatment (chromate, wood

preservatives), some wood types (such as oak or beech dust), metals, asbestos.

The risk from exposure to such substances will depend on how long you or people nearby are exposed to them.

Do not let particles enter the body.

Do the following to reduce exposure to these substances: ensure good ventilation of the workplace and wear appropriate protective equipment, such as respirators able to filter microscopically small particles.

Observe the relevant guidelines for your material, staff, application and place of application (e.g. occupational health and safety regulations, disposal).

Collect the generated particles at the source, avoid deposits in the surrounding area.

Use suitable accessories for special work, thus less particles enter the environment in an uncontrolled manner.

Use a suitable extraction unit.

Reduce dust exposure with the following measures:

- Do not direct the escaping particles and the exhaust air stream at yourself or nearby persons or on dust deposits.
- Use an extraction unit and/or air purifiers.
- Ensure good ventilation of the workplace and keep clean using a vacuum cleaner. Sweeping or blowing stirs up dust.

Vacuum or wash the protective clothing. Do not blow, beat or brush.

Transport of li-ion battery packs:

The shipping of li-ion battery pack is subject to laws related to the carriage of hazardous goods (UN 3480 and UN 3481). Inform yourself of the currently valid specifications when shipping li-ion battery packs. If necessary, consult your freight forwarder. Certified packaging is available from Metabo.

- Only send the battery pack if the housing is intact and no fluid is leaking. Remove the battery pack from the machine for sending. Prevent the contacts from short-circuiting (e.g. by protecting them with adhesive tape).

5. Overview

See page 2.

- 1 Saw blade tensioning device for jigsaw and reciprocating saw blades
- 2 LED working light
- 3 Front handle
- 4 Switch-on lock: To lock the trigger (10) to prevent the tool from switching on inadvertently.
- 5 Rear handle
- 6 Battery pack release button
- 7 Battery pack *
- 8 Capacity indicator button *
- 9 Capacity and signal indicator *
- 10 Trigger
- 11 Battery indicator to check the battery's charge level
- 12 Button for setting the guide
- 13 Guide

14 Saw blade

* depending on equipment/not in scope of delivery

6. Use

6.1 The machine's multifunctional monitoring system

 If the machine switches off automatically, the machine electronics have activated automatic protection mode.

Causes and remedies:

1. **Battery pack almost flat** (the electronics prevent the battery pack from discharging totally and avoid irreparable damage).

If the battery pack is almost flat, it must be recharged.

2. Long continuous overloading of the machine will activate the **temperature cut-out**.

Leave the machine or battery pack to cool.

Note: The machine will cool more quickly if you operate it at idling speed.

3. If the **current is too high** (for example, if the machine seizes continuously for long periods), the machine switches off.

Switch off the machine at the trigger (10). Then continue working as normal. Try to prevent the machine from seizing.

6.2 Battery pack

Charge the battery pack (7) before use.

Recharge the battery pack if performance diminishes.

The ideal storage temperature is between 10°C and 30°C.

"Li-Power, LiHD" lithium ion battery packs have a capacity and signal indicator (9):

- Press the button (8), the LEDs indicate the charge level.
- The battery pack is almost flat and must be recharged if one LED is flashing.

6.3 Removing and inserting the battery pack

To remove the battery pack: Press the battery pack release button (6) and remove the battery (7) pack.

To fit the battery pack: Slide in the battery pack (7) until it engages .

6.4 Fitting and removing the saw blade

 Before carrying out any work: Remove the battery pack.

 Do not touch the saw blade immediately following operation of the tool, as it can be extremely hot and can lead to skin burns.

 Use jigsaw saw blades as a general rule.

- 1 Turn the clamping sleeve (1) in the direction of the arrow and hold it.
- 2 Insert the saw blade (14) as far as the limit stop or remove it.
- 3 Release the clamping sleeve (1) (the clamping sleeve rotates back to its original position).
- 4 Check that the saw blade is securely seated.

Note when using **jig saw blades**: Both sabre saw and jig saw blades can be used. Use sabre saw blades as a general rule. When inserting jig saw blades, ensure that the jig saw blade is inserted in a vertical position as far as the limit stop. Slowly turn the clamping sleeve (1) back to its original position and ensure that the jig saw blade is fitting into the recess.

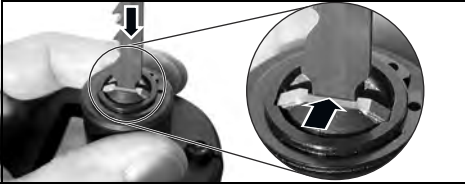

Note: Should it occur that a saw blade has broken off and it cannot be removed by hand from the saw blade quick-clamping device, turn the clamping sleeve (1) in the direction of the arrow and hold it. Engage the tip of a saw blade in the broken section and pull it out. A fine-toothed metal saw blade is best suited for this task.

6.5 Setting the guide

The cutting depth can be limited by shifting the guide (13) (e.g. when sawing in front of a wall).

Occasionally shift the guide (13) to achieve even wear of the saw blade.



- 1 Press the button (12) and shift the guide (13) to the desired position.
- 2 Release the button (12) and shift the guide until it engages.



Check the guide (13) to ensure that it is securely fitted.

7. Use

7.1 Switching on and off, stroke rate, switch-on lock (4):

-  Trigger (10) locked.
-  Trigger (10) unlocked.

Switching on, speed: Press the trigger (10). The stroke rate can be changed by pressing in the trigger.

Switching off: Release the trigger (10).

7.2 Working instructions

Sawing:

Use a saw blade geared to the material to be sawn.

Press the machine with the guide (13) against the workpiece. Switch on the machine, and only then guide the saw blade against the workpiece.

Do not make contact with any objects or with the ground with the moving saw blade (risk of recoil or of breaking the saw blade).

Adapt the stroke rate to the material to be sawn.

Avoid excessive pressure on the saw blade (particularly in the case of long saw blades).

If the saw blade jams, turn the machine off immediately. Widen the sawn gap slightly with a suitable tool and take out the machine.

After completing the sawing cut, switch off the machine and only take it out of the sawn gap to place it down once the saw blade has come to a standstill (danger of recoil).

Lock the machine with the switch-on lock (4) to prevent it from switching on inadvertently.

Plunge cuts:

Plunge cuts may only be made in soft materials such as wood or plastic. Only use short saw blades.

Hold the machine with both hands at the intended handles, take a secure stance and concentrate on the work.

See illustration, page 3: The machine is pressed with the edge of the guide (13) against the workpiece. The saw blade does not make contact with the workpiece. Switch on machine. The corner of the guide serves as a pivot point around which the machine is slowly aligned, whereby the saw blade cuts into the workpiece.

8. Servicing

On a regular basis, use compressed air to blow out the machine through the motor ventilation slots.

Clean regularly: Press button (12) and remove guide (13). Hold the device downwards in a vertical position without the saw blade and, using your hand, lightly tap on the machine. The accumulated dust falls out. Do not oil or grease.

9. Accessories

Only use original Metabo battery packs and Metabo accessories.

See page 4.

Use only accessories which fulfil the requirements and specifications listed in these operating instructions.

- A Comprehensive range of saw blades for a wide variety of materials and use cases
- B Battery charger
- C Battery packs
- D Lubricating stick for cooling the saw blades when sawing metal

For a complete range of accessories, see www.metabo.com or the catalogue.

10. Repairs

 Repairs to electrical tools must be carried out by qualified electricians ONLY!

If you have Metabo electrical tools that require repairs, please contact your Metabo service centre. For addresses see www.metabo.com.

You can download spare parts lists from www.metabo.com.

$a_{h, WB}$ = Vibration emission level (sawing wood, 100x100 mm)

$K_{h, ...}$ = Uncertainty (vibration)

Typical A-effective perceived sound levels:

L_{pA} = Sound pressure level

L_{WA} = Acoustic power level

K_{pA}, K_{WA} = Uncertainty

During operation the noise level can exceed 80 dB(A).



Wear ear protectors!

11. Environmental Protection

Observe national regulations on environmentally compatible disposal and on the recycling of disused machines, packaging and accessories.

Battery packs must not be disposed of with regular waste. Return faulty or used battery packs to your Metabo dealer!

Do not allow battery packs to come into contact with water!

 Only for EU countries: Never dispose of power tools in your household waste! In accordance with European Guideline 2002/96/EC on used electronic and electric equipment and its implementation in national legal systems, used power tools must be collected separately and handed in for environmentally compatible recycling. Before disposal, discharge the battery pack in the power tool. Prevent the contacts from short-circuiting (e. g. by protecting them with adhesive tape).

12. Technical Specifications

Explanatory notes on the specifications on page 3.

Changes due to technological progress reserved.

U = Voltage of battery pack

n_0 = Stroke rate at idle speed

s = Stroke length

m = Weight (with smallest battery pack)

Measured values determined in conformity with EN 60745.

== Direct current

The technical specifications quoted are subject to tolerances (in compliance with the relevant valid standards).

Emission values

Using these values, you can estimate the emissions from this power tool and compare these with the values emitted by other power tools. The actual values may be higher or lower, depending on the particular application and the condition of the tool or power tool. In estimating the values, you should also include work breaks and periods of low use. Based on the estimated emission values, specify protective measures for the user - for example, any organisational steps that must be put in place.

Vibration total value (vector sum of three directions) determined in accordance with EN 60745:

$a_{h, B}$ = Vibration emission level (Sawing chip board, 38 mm)

metabo[®]

PROFESSIONAL POWER TOOL SOLUTIONS